

MAINE DEPARTMENT OF TRANSPORTATION  
MAINE WOODS TO WATER RAIL CONNECTION PROJECT  
CONSOLIDATED RAIL INFRASTRUCTURE AND SAFETY  
IMPROVEMENTS (CRISI) 2022

**ATTACHMENT 11  
DESIGN DRAWINGS**

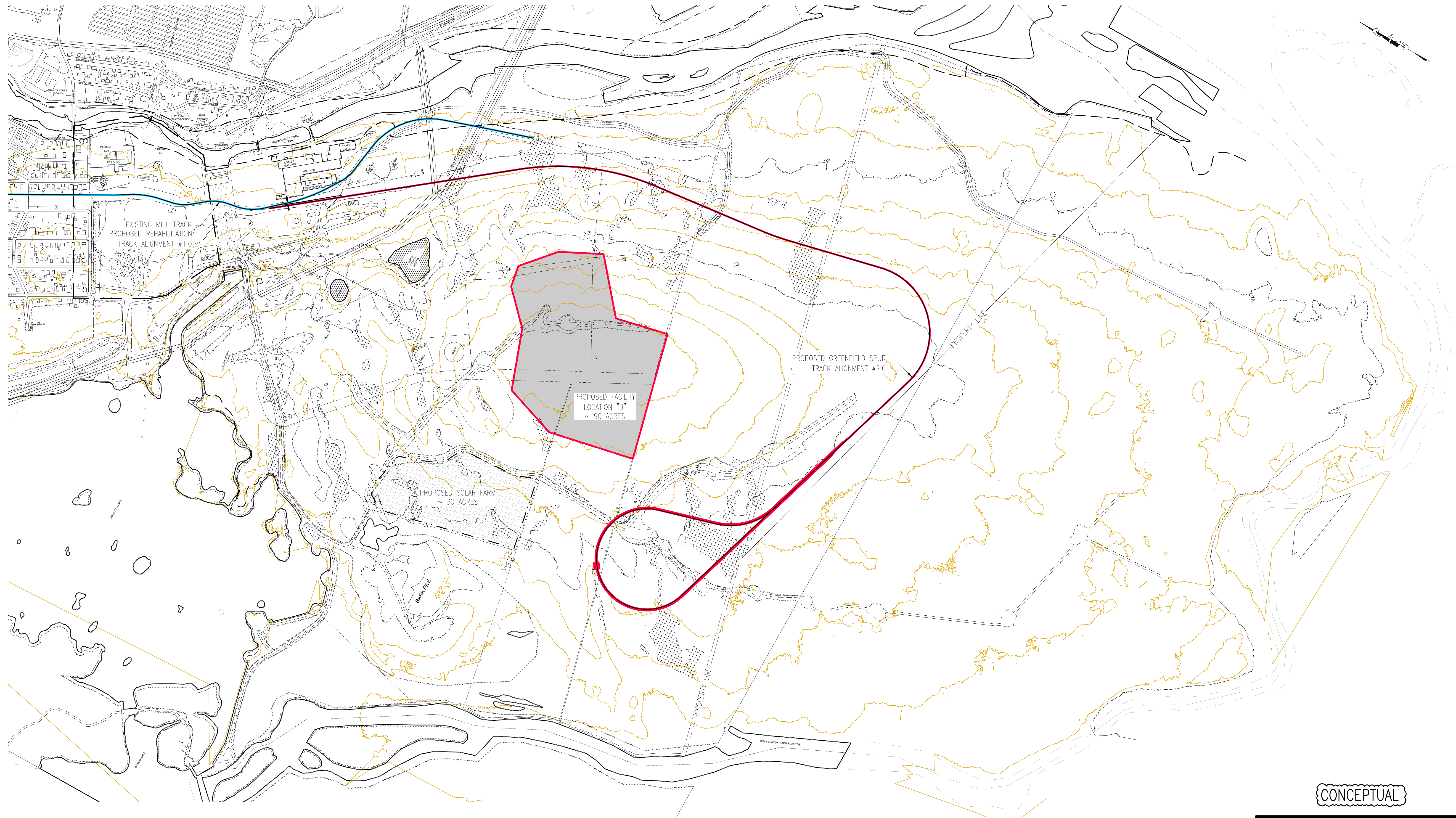

KEY		
COLOR	TRACK	NUMBER
Blue	EXISTING MILL TRACK	#1.00
Red	PROPOSED GREENFIELD SPUR AND LOOP	#2.00
Yellow	PROPOSED YARD TRACK	#10.00
Pink	EXISTING SIDE OR YARD TRACK	#20.00
Blue	EXISTING RAILROAD MAIN LINE	#30.00

CONCEPTUAL

ONE NORTH  
MILLINOCKET, MAINE

MILLINOCKET MILL SITE - RAIL DEVELOPMENT  
CONCEPTUAL TRACK LAYOUTS  
SITE OVERVIEW

**TEC ASSOCIATES** CONSULTING ENGINEERS  
40 MECHANIC STREET SOUTH PORTLAND, MAINE 04106

SCALE 1" = 500' DATE 9 SEPTEMBER 2022

JOB NUMBER 19267-1 DRAWN BY B.E.A. DESIGNED BY B.E.A. DRAWING NO. --

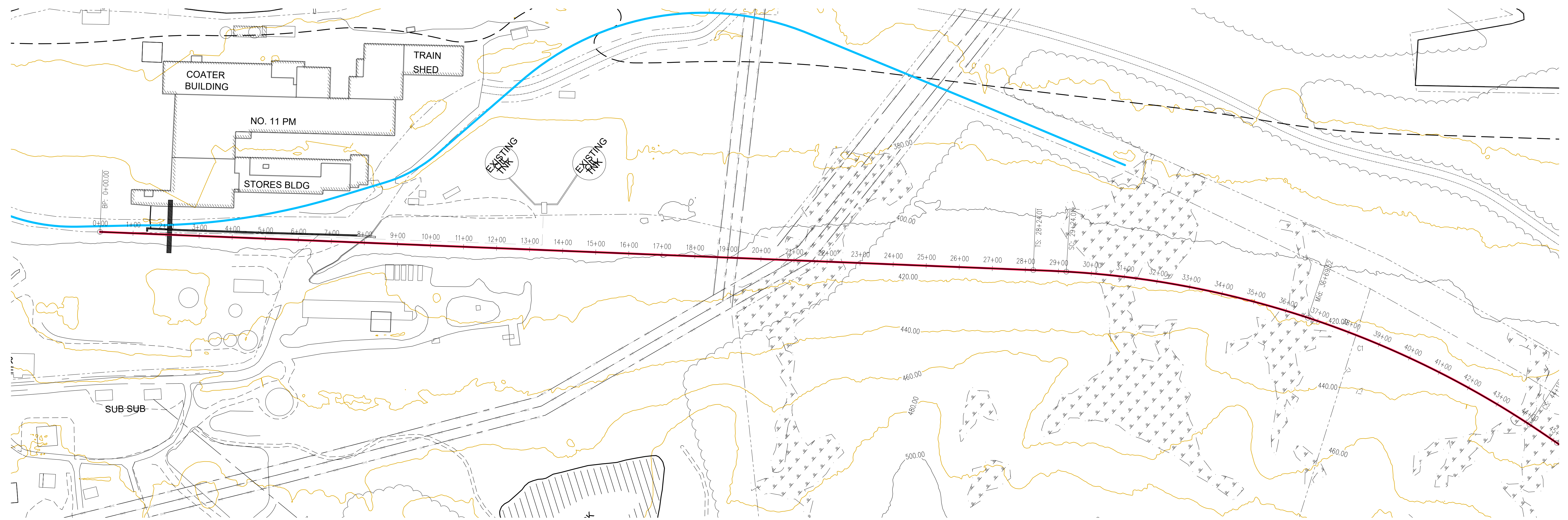

PLAN

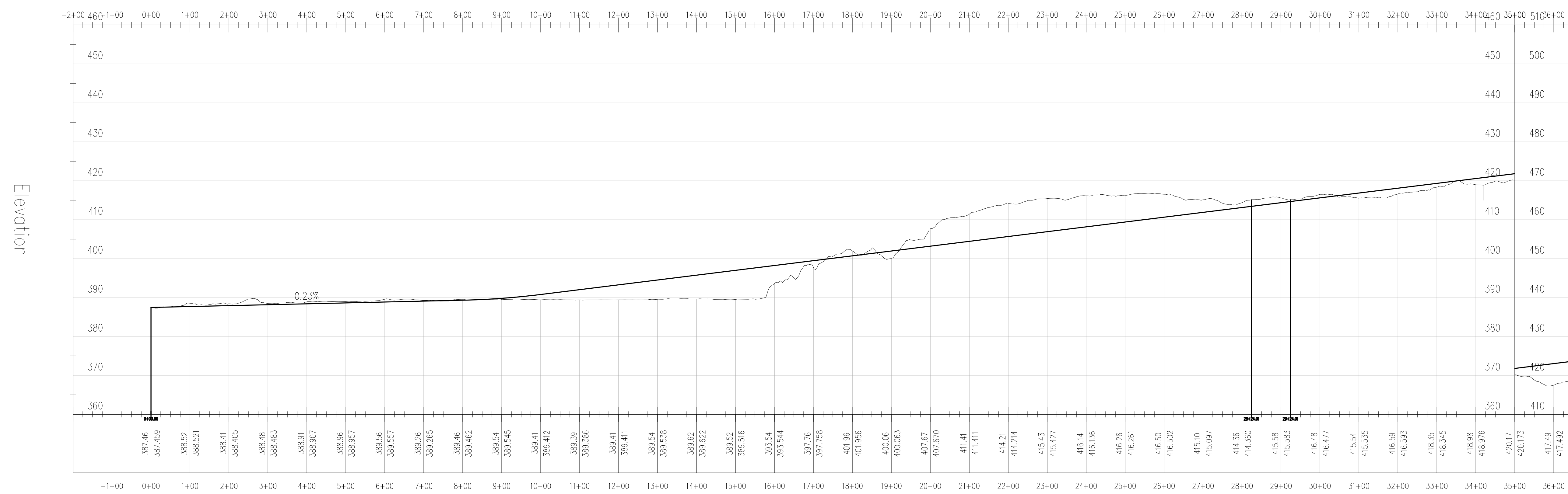

PROFILE

CONCEPTUAL

**ONE NORTH  
MILLINOCKET, MAINE**

MILLINOCKET MILL SITE - RAIL DEVELOPMENT  
PROPOSED GREENFIELD SPUR  
TRACK PLAN AND PROFILE

**TEC ASSOCIATES** CONSULTING ENGINEERS  
40 MECHANIC STREET SOUTH PORTLAND, MAINE 04106

SCALE 1" = 150'	DATE 9 SEPTEMBER 2022
JOB NUMBER 22314-1	DESIGNED BY B.E.A.
DRAWN BY B.E.A.	DESIGNED BY B.E.A.

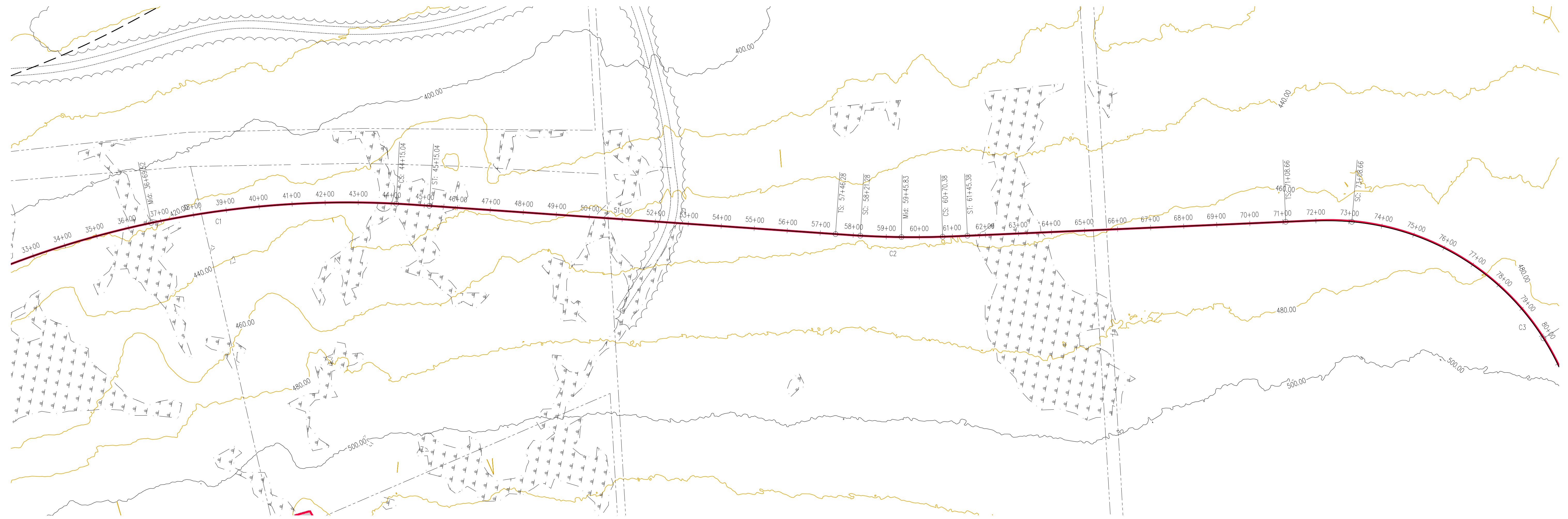

PLAN

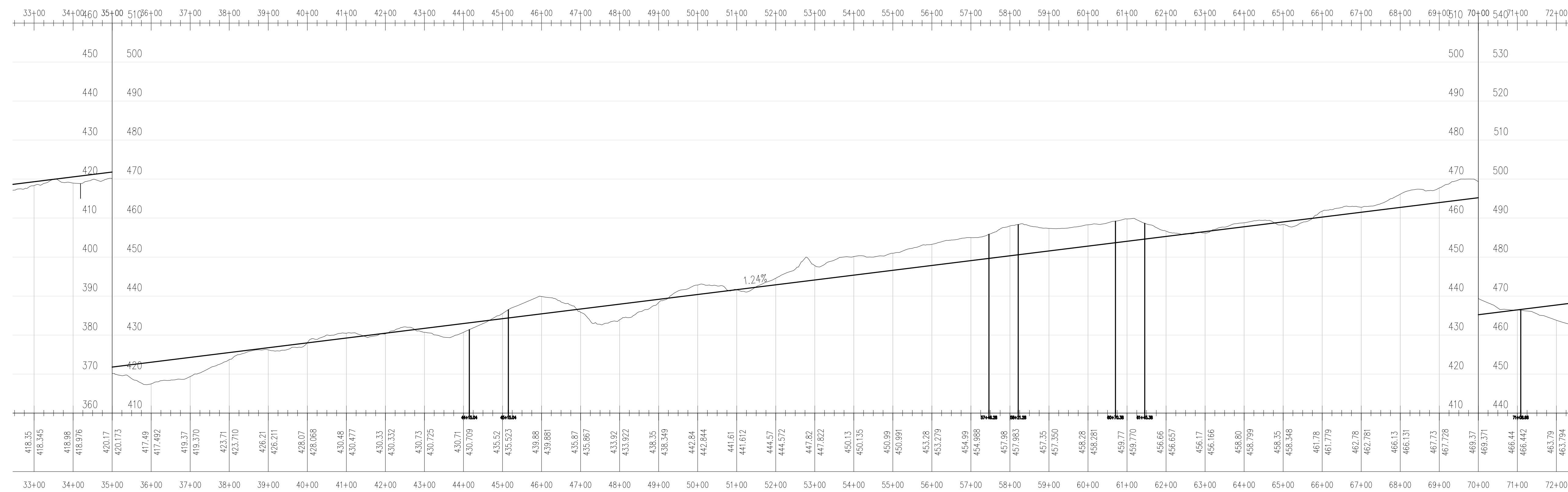

PROFILE

CONCEPTUAL

<b>ONE NORTH MILLINOCKET, MAINE</b>	
MILLINOCKET MILL SITE - RAIL DEVELOPMENT PROPOSED GREENFIELD SPUR TRACK PLAN AND PROFILE	
 CONSULTING ENGINEERS	
SCALE 1" = 150'	DATE 9 SEPTEMBER 2022
JOB NUMBER 22314-1	DRAWN BY B.E.A. DESIGNED BY B.E.A. DRAWING NO. ---

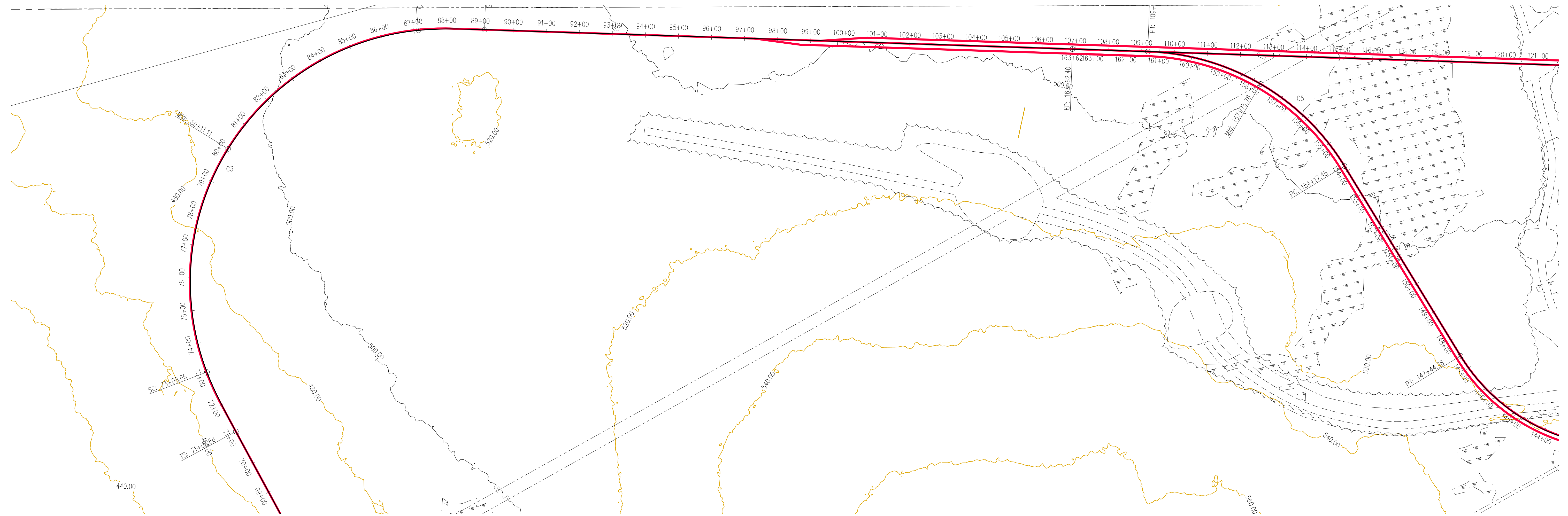

PLAN

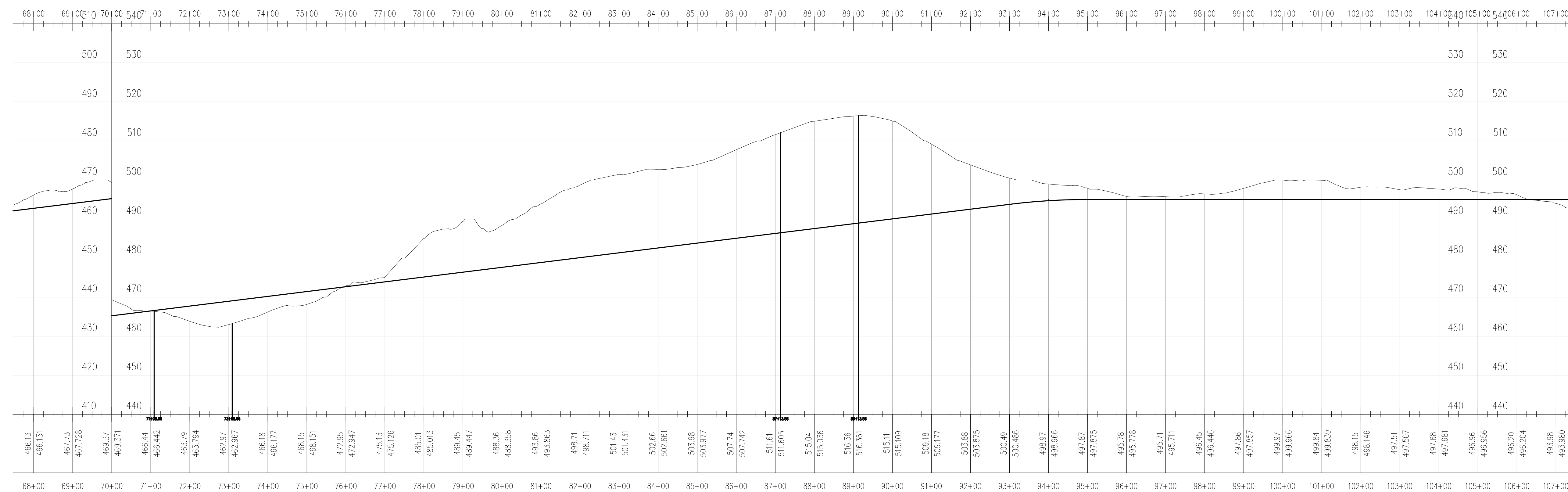

PROFILE

CONCEPTUAL

**ONE NORTH  
MILLINOCKET, MAINE**

MILLINOCKET MILL SITE - RAIL DEVELOPMENT  
PROPOSED GREENFIELD SPUR  
TRACK PLAN AND PROFILE

**TEC ASSOCIATES** CONSULTING ENGINEERS  
40 MECHANIC STREET SOUTH PORTLAND, MAINE 04106

SCALE 1" = 150'	DATE 9 SEPTEMBER 2022
JOB NUMBER 22314-1	DESIGNED BY B.E.A.
DRAWN BY B.E.A.	DESIGNED BY B.E.A.
	DRAWING NO. --

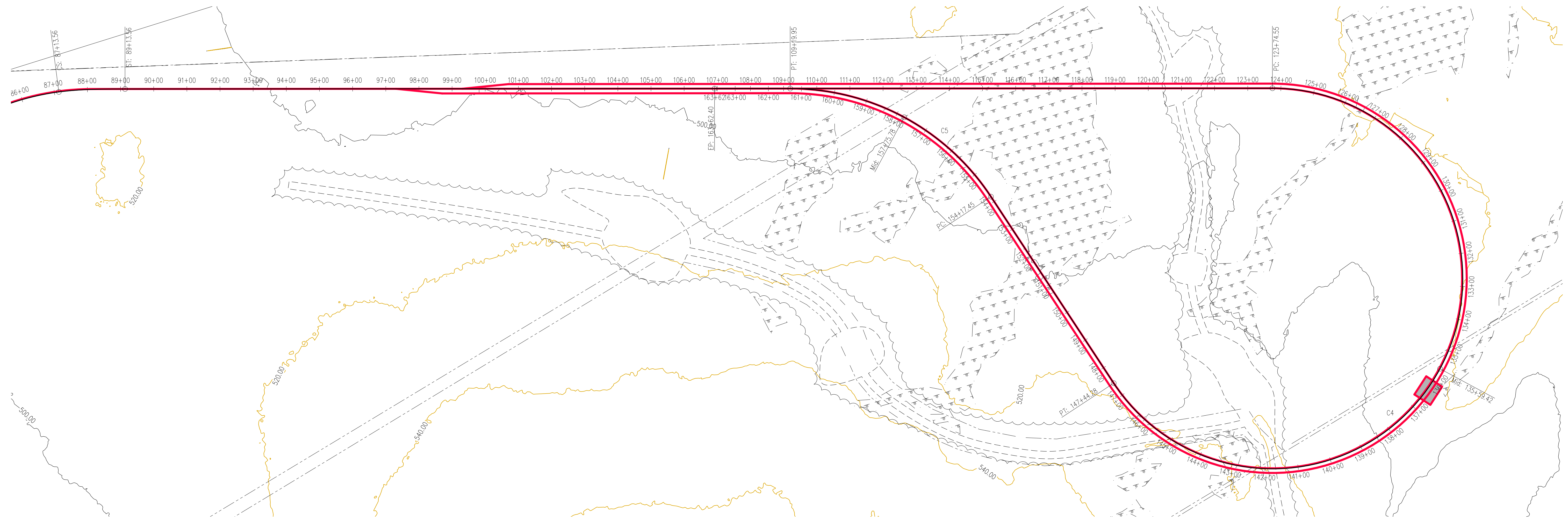

PLAN

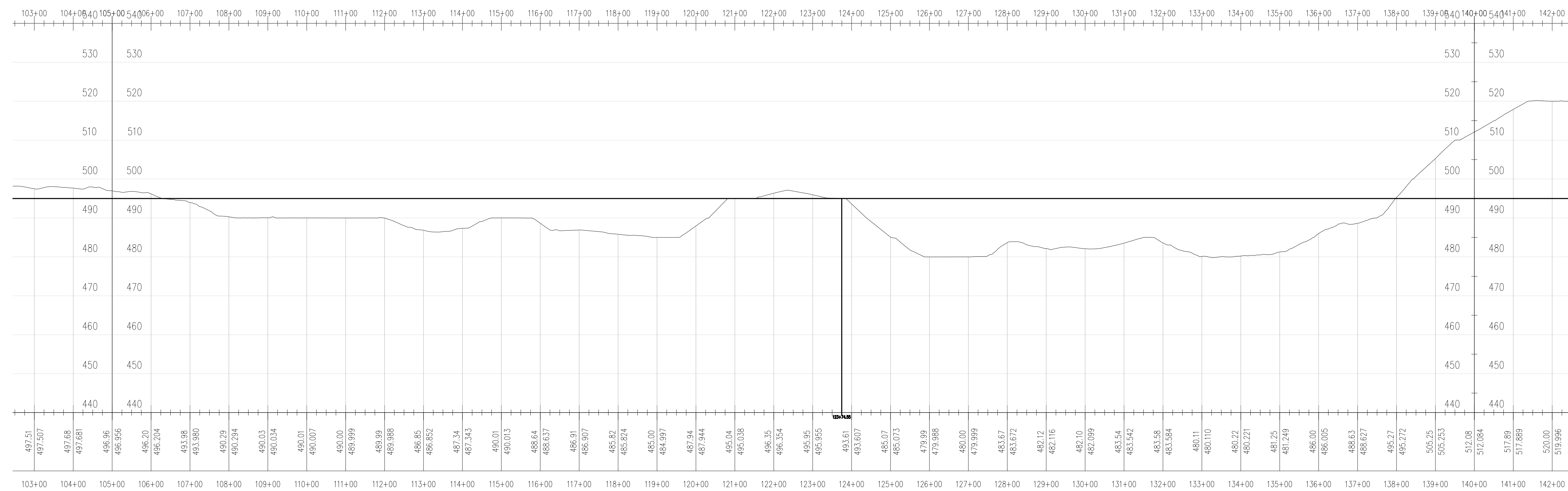

PROFILE

CONCEPTUAL

<b>ONE NORTH MILLINOCKET, MAINE</b>	
MILLINOCKET MILL SITE - RAIL DEVELOPMENT PROPOSED GREENFIELD SPUR TRACK PLAN AND PROFILE	
<b>TEC ASSOCIATES</b> CONSULTING ENGINEERS 40 MECHANIC STREET SOUTH PORTLAND, MAINE 04106	
SCALE 1" = 150'	DATE 9 SEPTEMBER 2022
JOB NUMBER 22314-1	DESIGNED BY B.E.A.
DRAWN BY B.E.A.	ENGINEERED BY B.E.A.

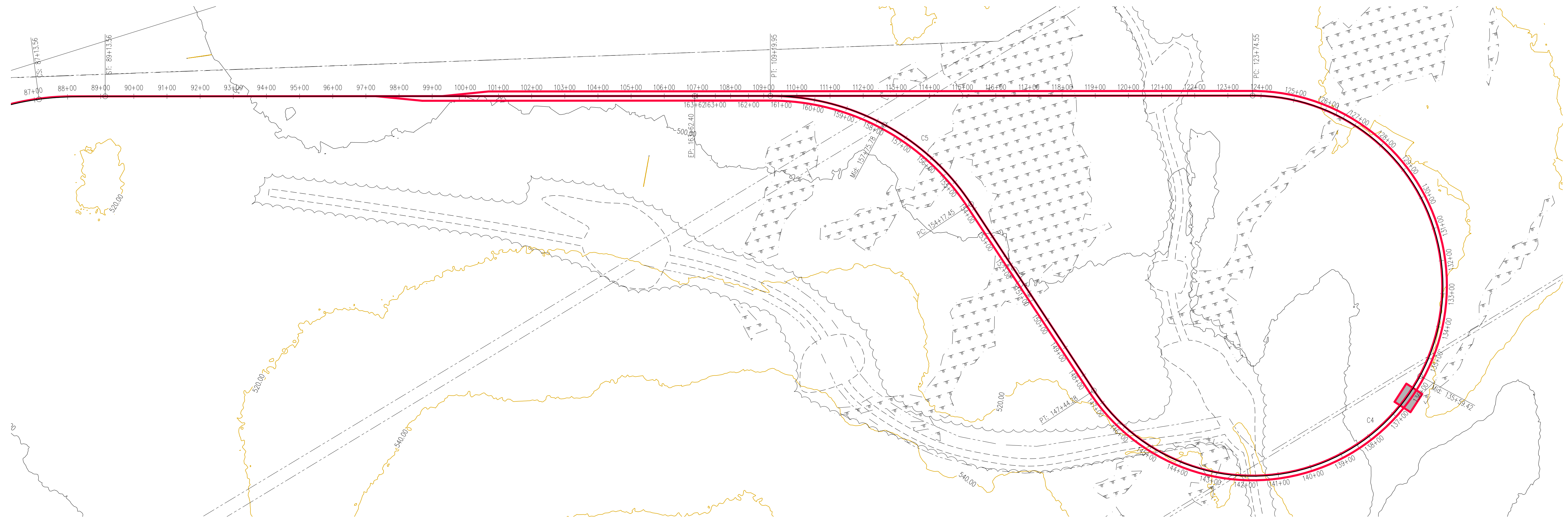

PLAN

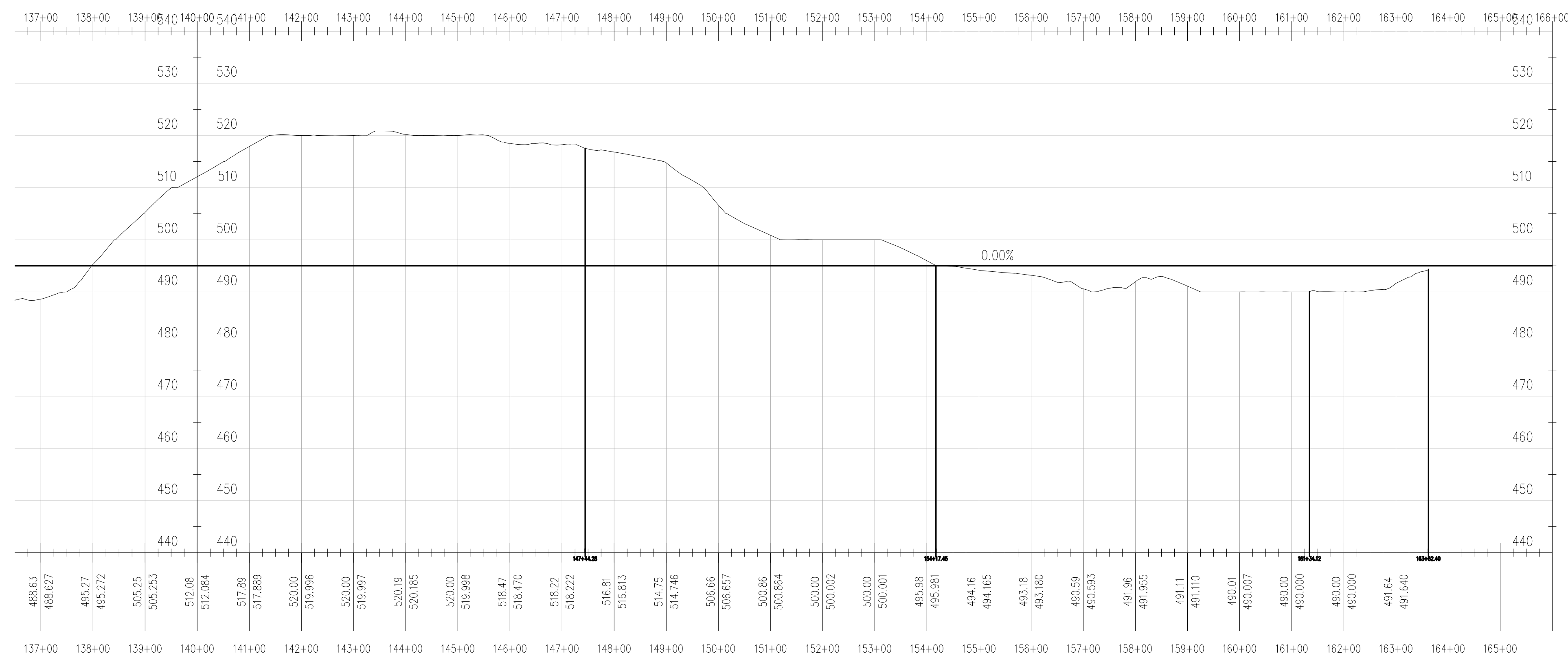

PROFILE

Curve Table: Alignments						
Curve #	Degree	Radius	Length	Chord Direction	Start Point	End Point
C1	2.00	2864.79	1491.04	S22° 23' 17.08"E	(18306.46,14956.35)	(18867.98,13593.20)
C2	2.00	2864.79	249.10	S9° 43' 07.30"E	(19027.53,12196.05)	(19069.56,11950.60)
C3	7.50	764.50	1404.90	S47° 10' 49.08"W	(19338.38,10742.17)	(18446.89,9916.07)
C4	10.00	573.69	2369.73	N45° 39' 20.37"E	(14949.65,10997.58)	(15671.88,11703.47)
C5	7.91	724.58	716.67	S44° 20' 39.63"E	(15857.53,11056.41)	(16338.29,10564.52)

CONCEPTUAL

**ONE NORTH  
MILLINOCKET, MAINE**

MILLINOCKET MILL SITE - RAIL DEVELOPMENT  
PROPOSED GREENFIELD SPUR  
TRACK PLAN AND PROFILE

**TEC ASSOCIATES** CONSULTING ENGINEERS  
40 MECHANIC STREET SOUTH PORTLAND, MAINE 04106

SCALE 1" = 150'	DATE 9 SEPTEMBER 2022
JOB NUMBER 22314-1	DRAWN BY B.E.A.
DESIGNED BY B.E.A.	DRAWING NO. --

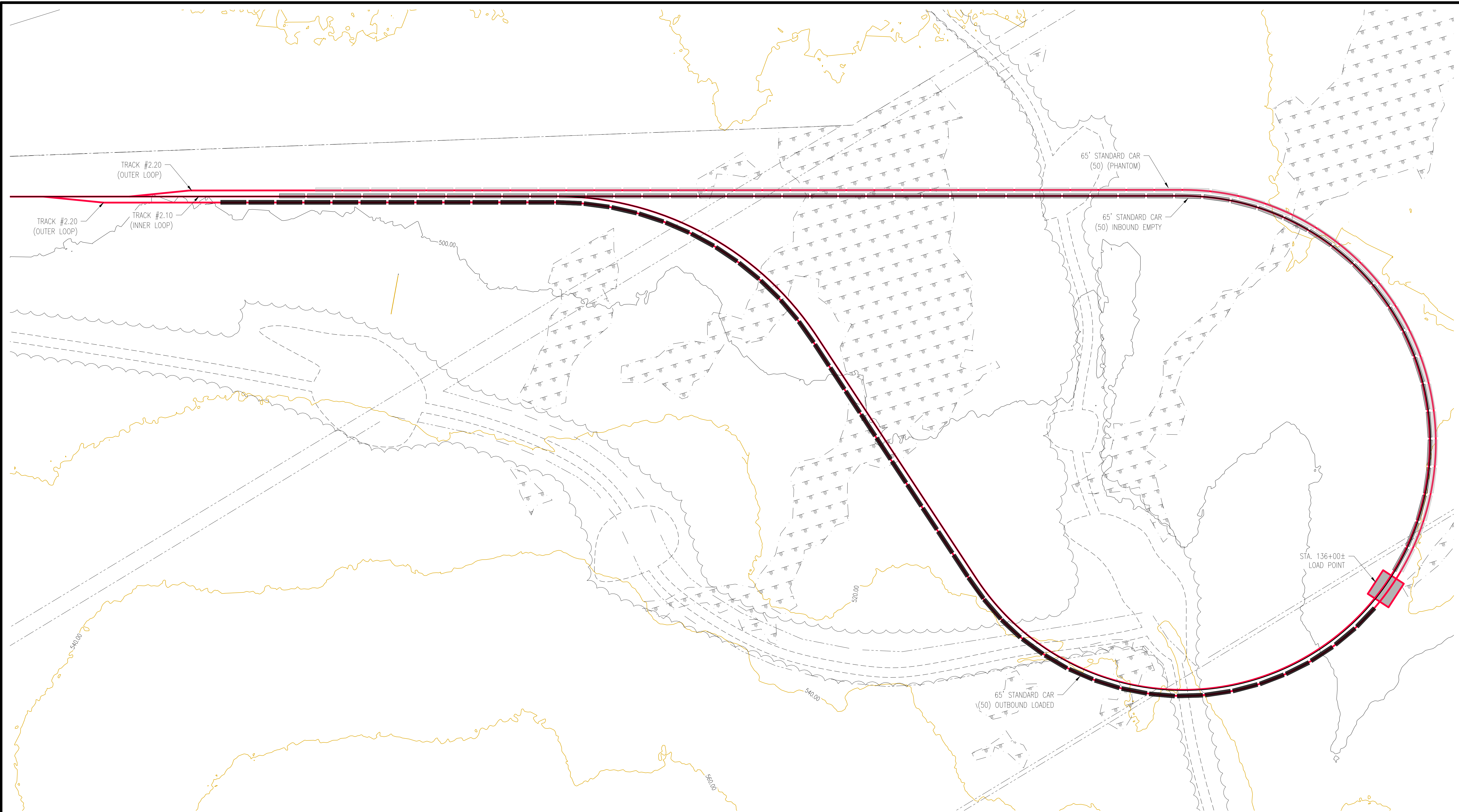

SERVICE PLAN

TRACK #	TRACK FEET	CAPACITY	DESIGNATION
#2.10	6,100± T.F.	(50)	INNER LOOP (INCLUDING LEAD)
#2.20	7,000± T.F.	(50)	OUTER LOOP
#2.00 SPUR	9,600± T.F.	---	GREENFIELD SPUR
	22,700± T.F.	(100)	TOTAL

CONCEPTUAL

<b>ONE NORTH MILLINOCKET, MAINE</b>	
MILLINOCKET MILL SITE - RAIL DEVELOPMENT PROPOSED GREENFIELD SPUR LOOP TRACK AND SERVICE PLAN	
 CONSULTING ENGINEERS <small>40 MECHANIC STREET SOUTH PORTLAND, MAINE 04106</small>	
SCALE 1" = 100'	DATE 9 SEPTEMBER 2022
<small>JOB NUMBER 22314-1</small>	<small>DESIGNED BY B.E.A.</small>
<small>DRAWN BY B.E.A.</small>	<small>DRAWING NO. ---</small>



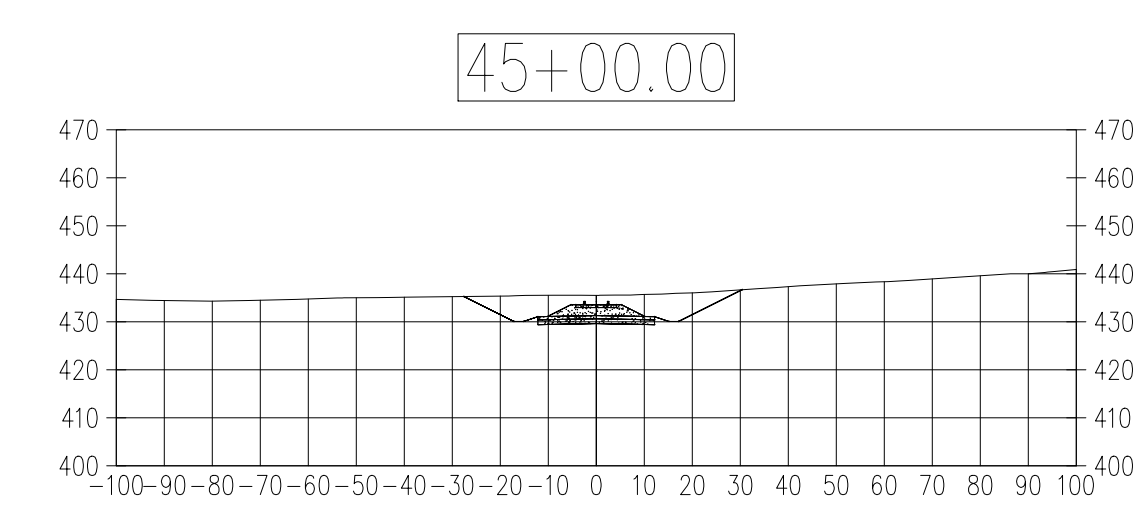
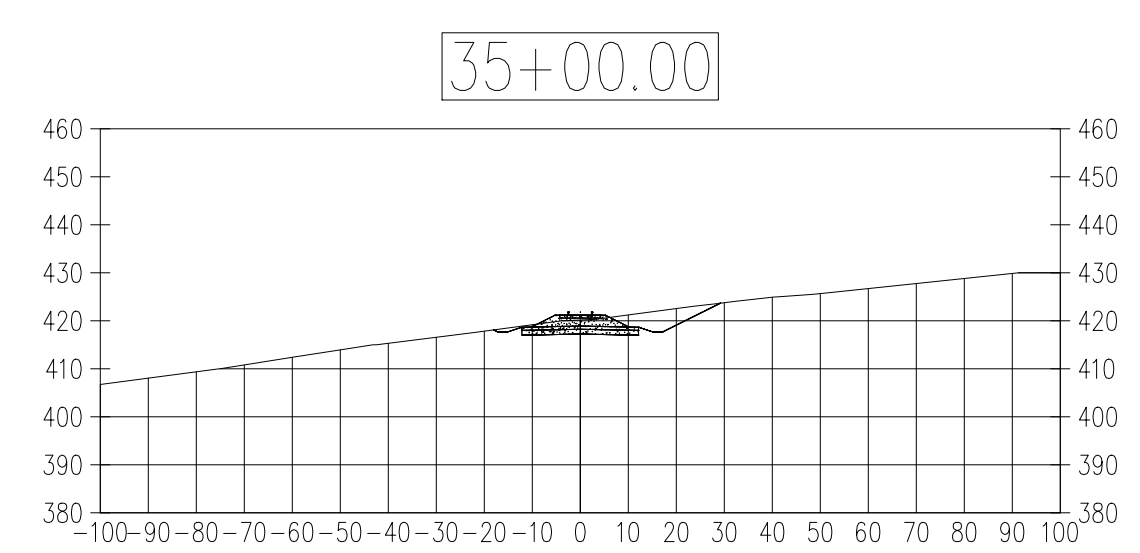
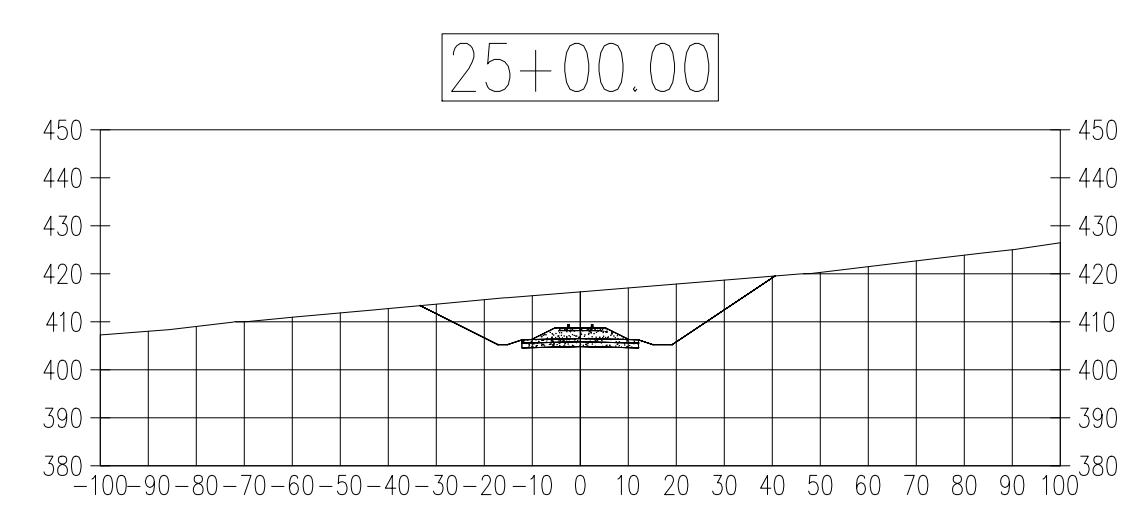
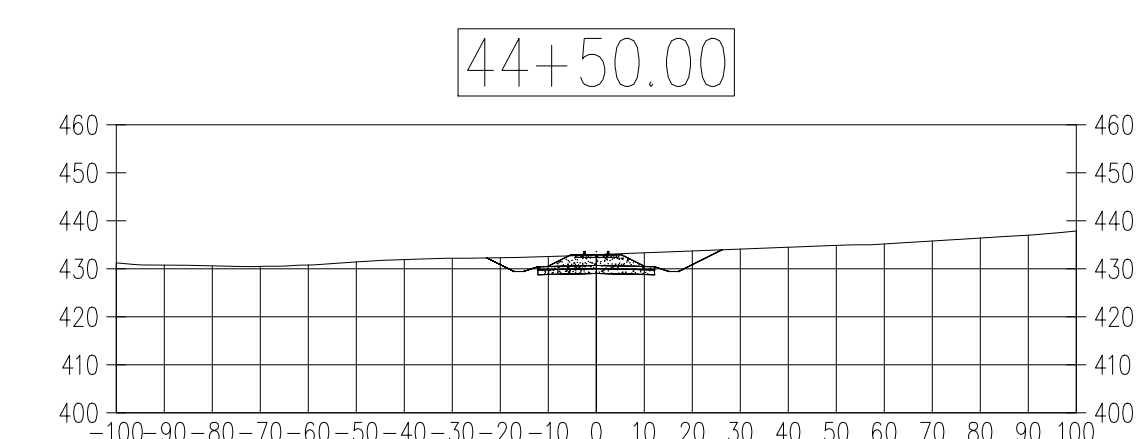
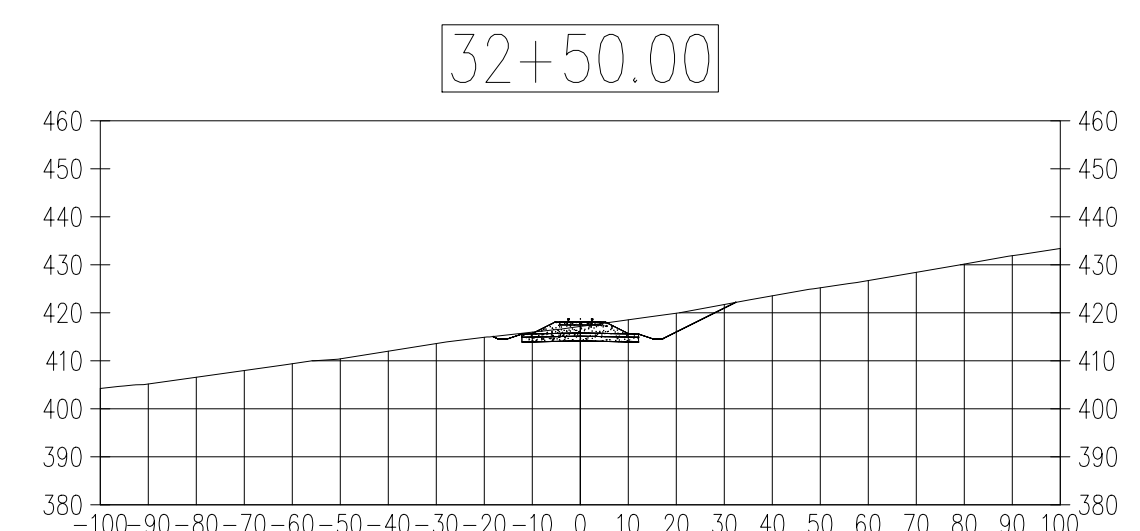
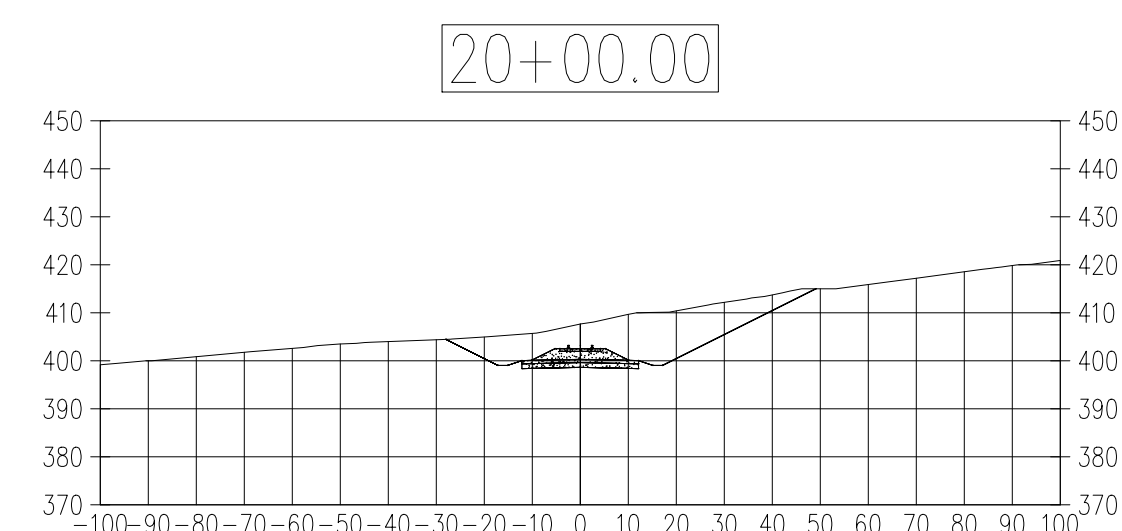
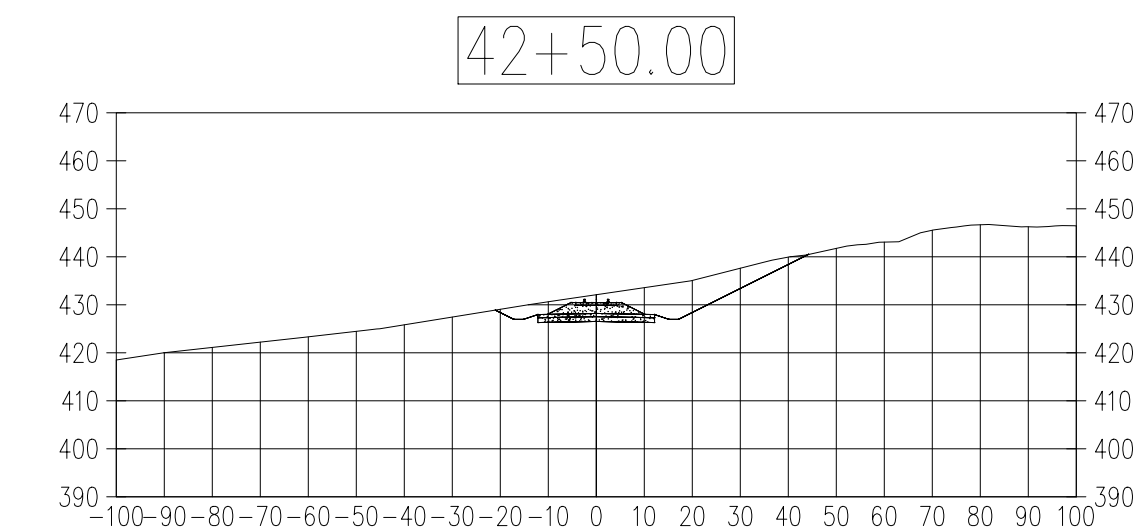
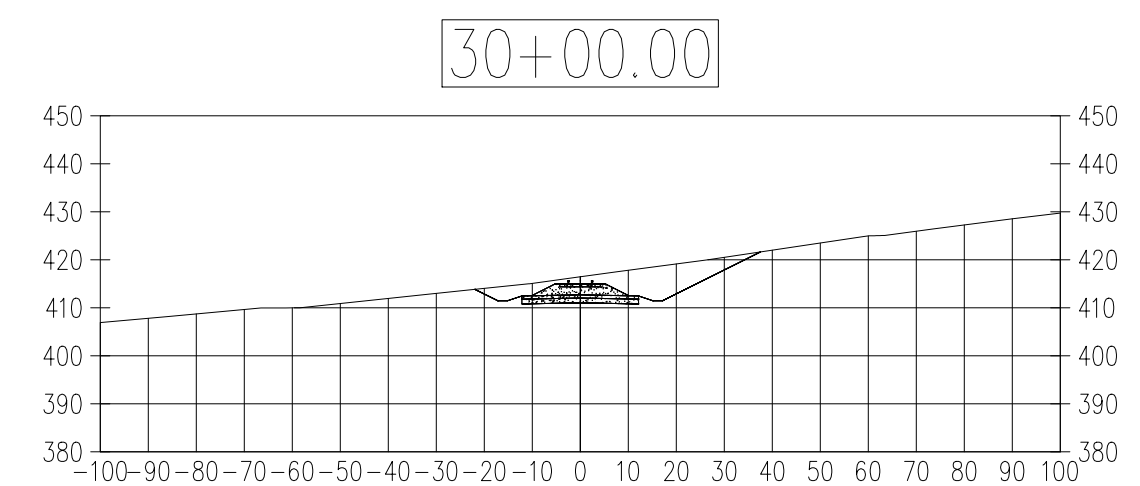
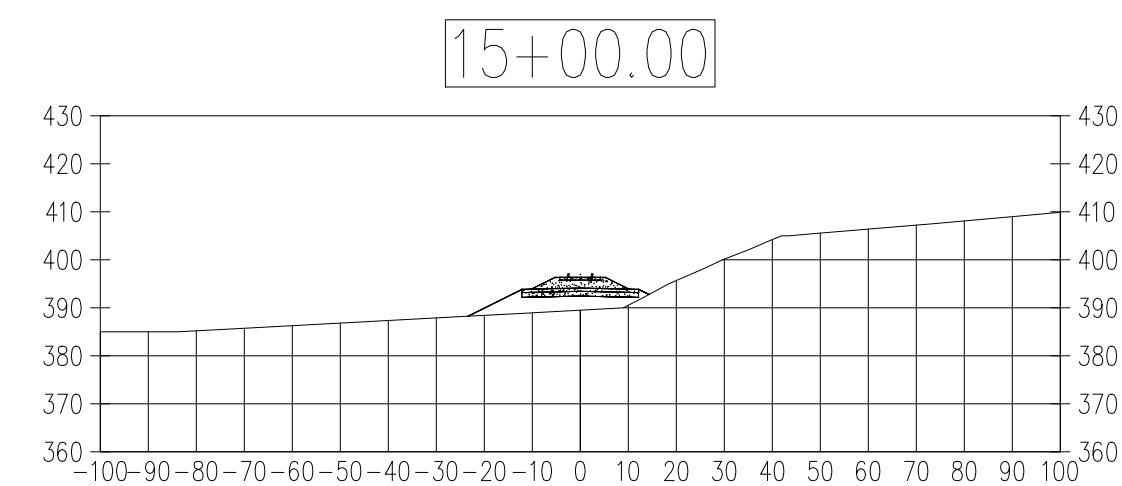
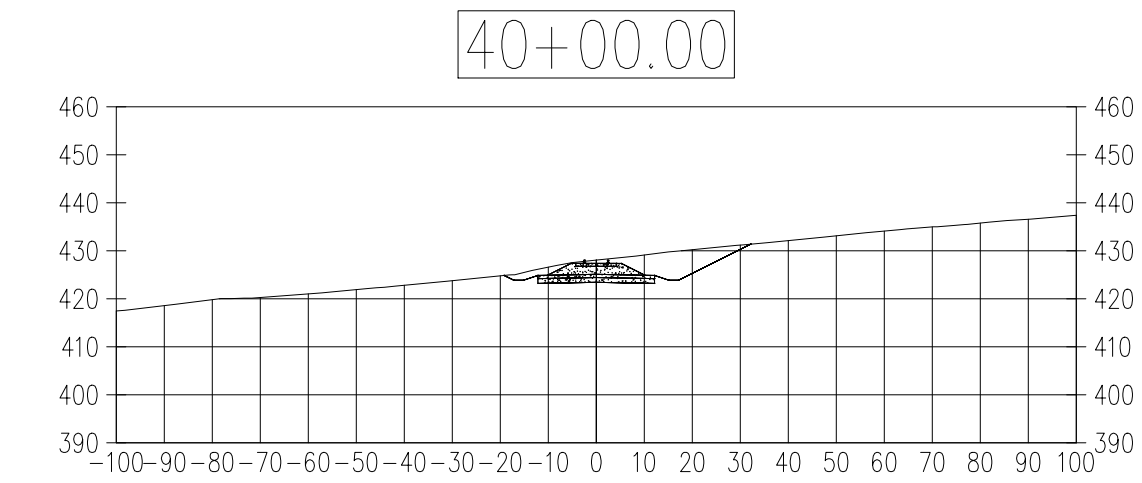
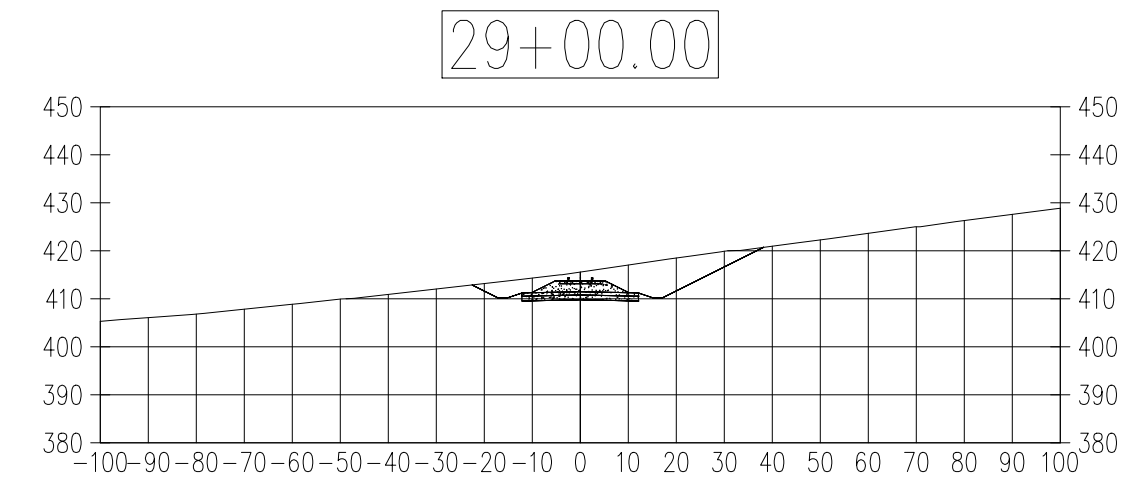
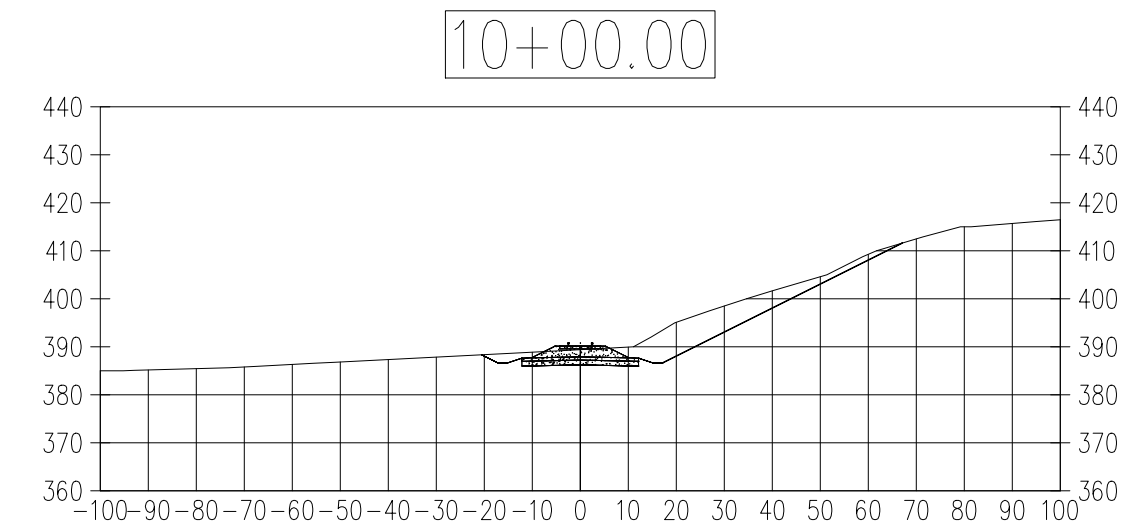
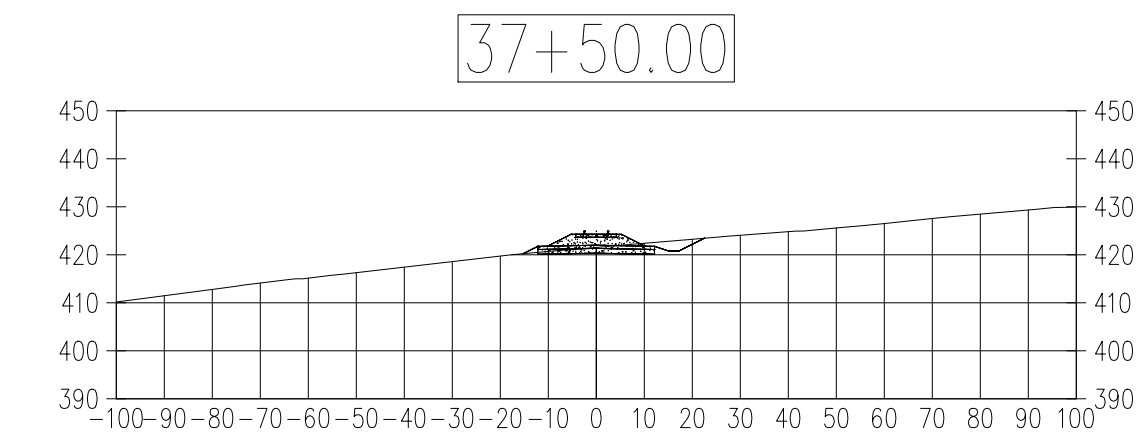
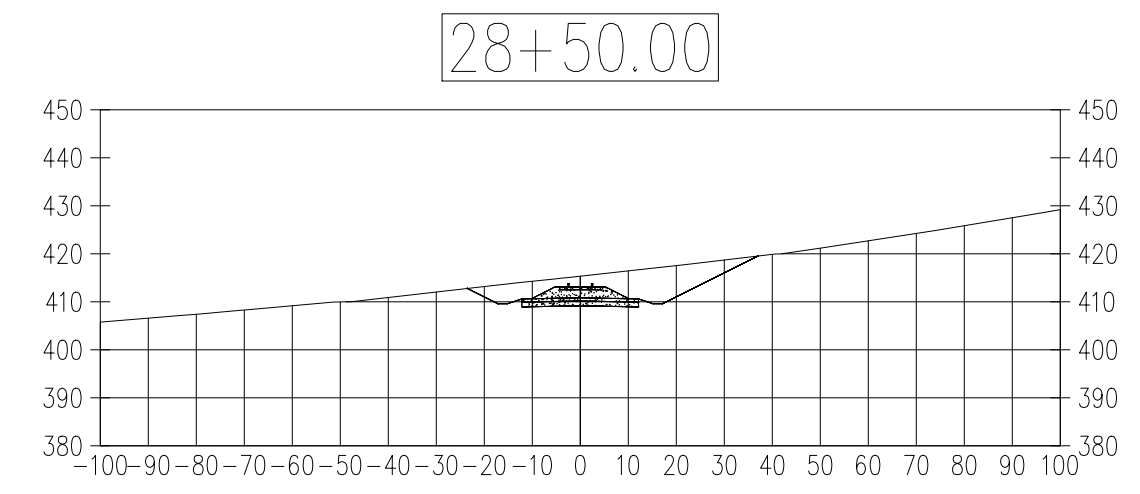
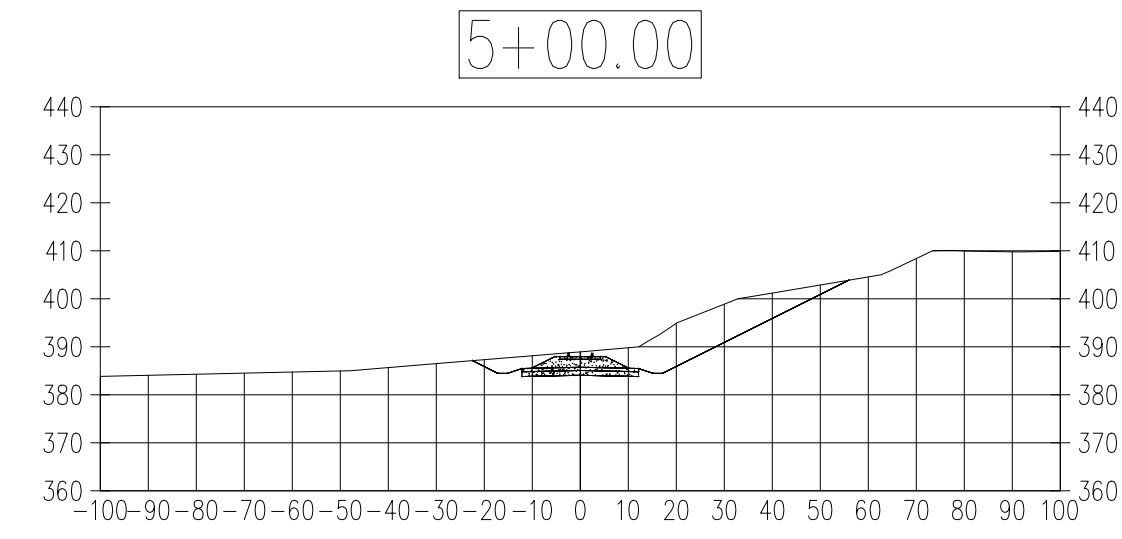

CONCEPTUAL

<b>ONE NORTH MILLINOCKET, MAINE</b>			
MILLINOCKET MILL SITE - RAIL DEVELOPMENT PROPOSED LOOP TRACK SECTIONS			
		<small>CONSULTING ENGINEERS</small>	
<small>40 MECHANIC STREET SOUTH PORTLAND, MAINE 04106</small>		<small>DATE 24 AUGUST 2022</small>	
<b>SCALE 1" = 100'</b>		<b>DESIGNED BY B.E.A.</b>	
<small>JOB NUMBER 22314-1</small>		<small>DRAWN BY B.E.A.</small>	
<small>DESIGNED BY B.E.A.</small>		<small>DRAWING NO. --</small>	

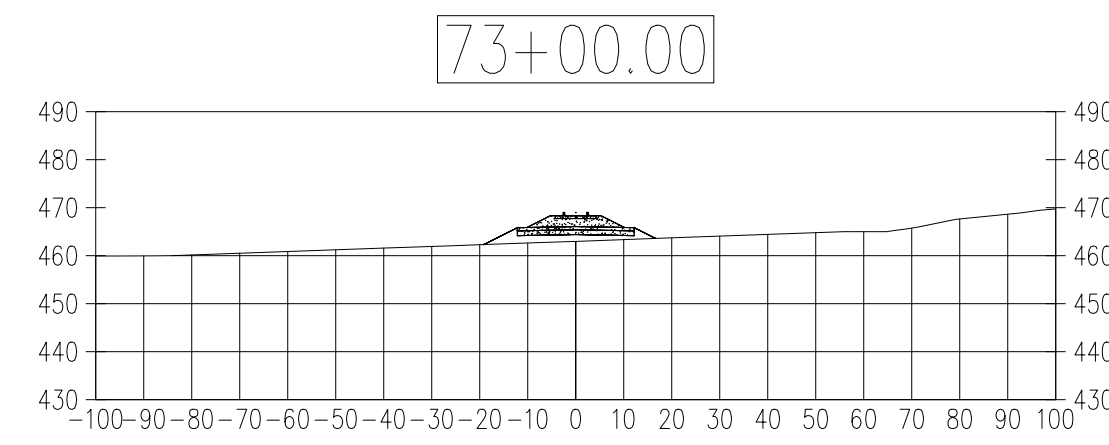
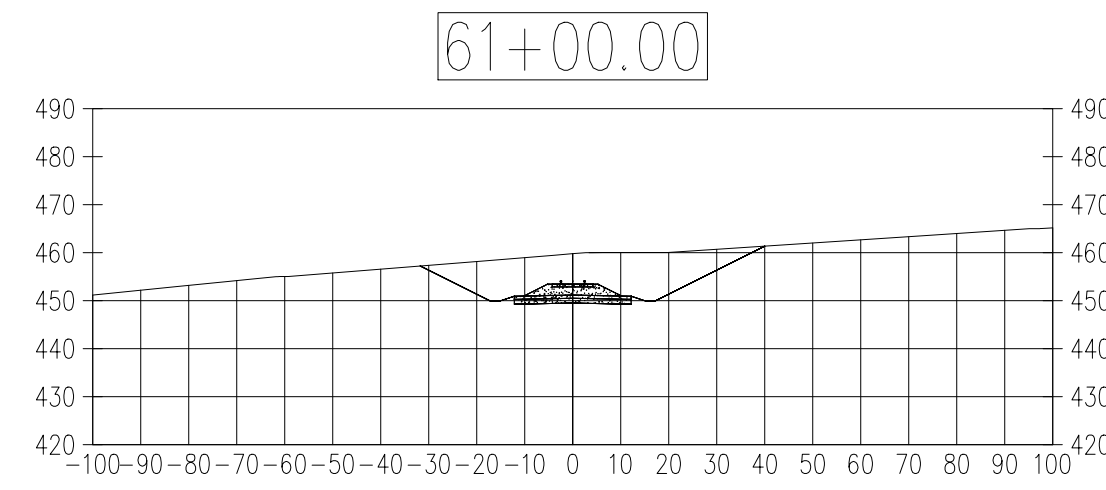
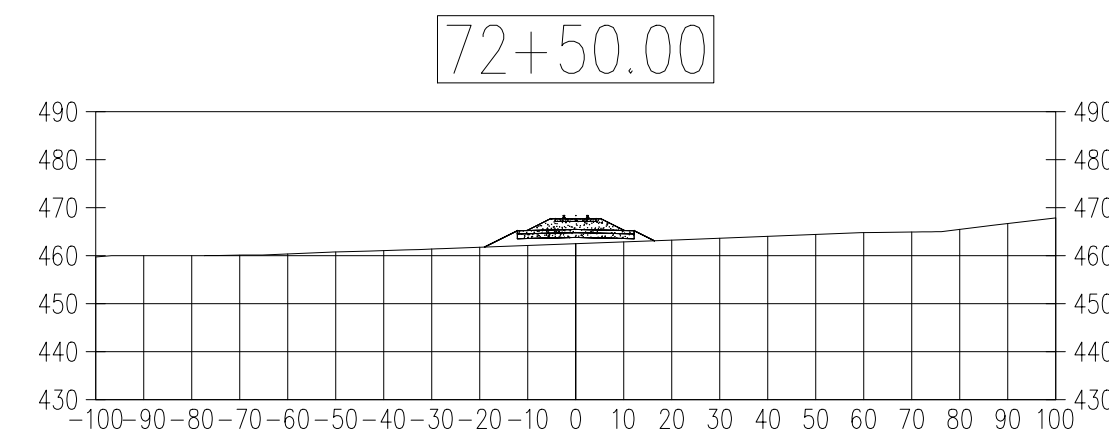
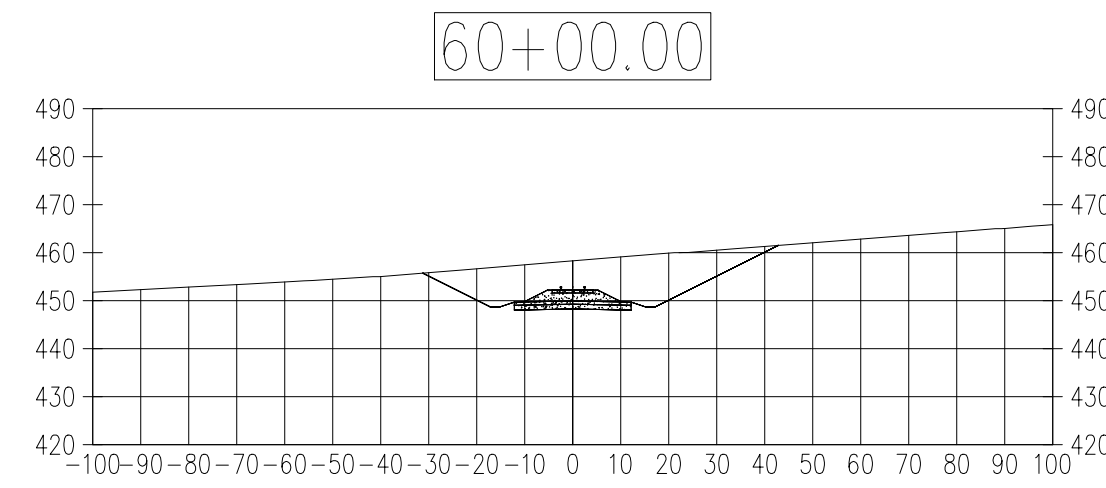
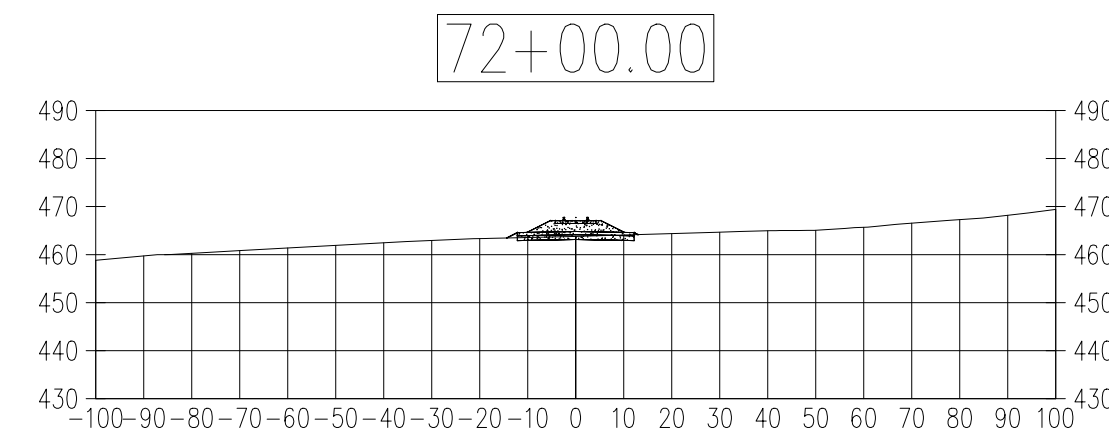
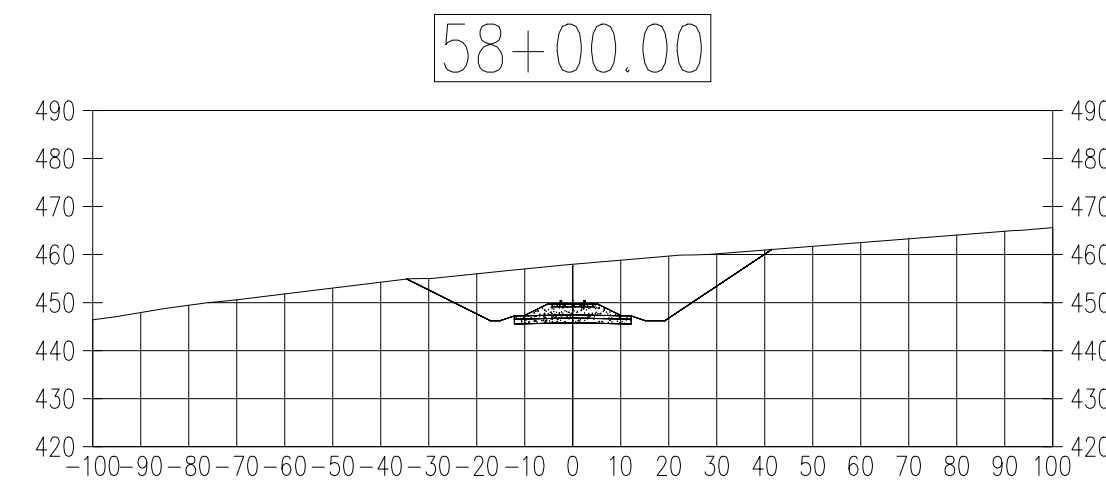
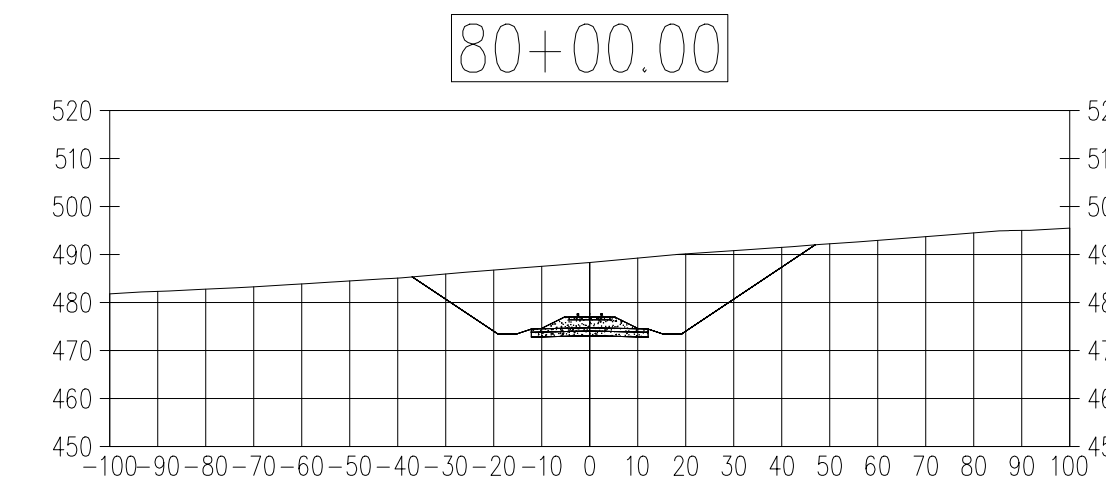
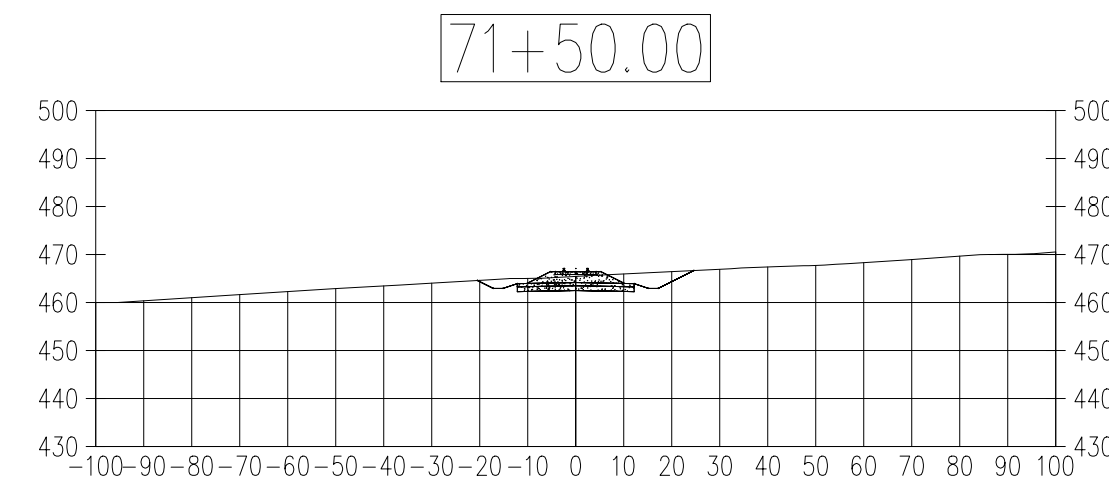
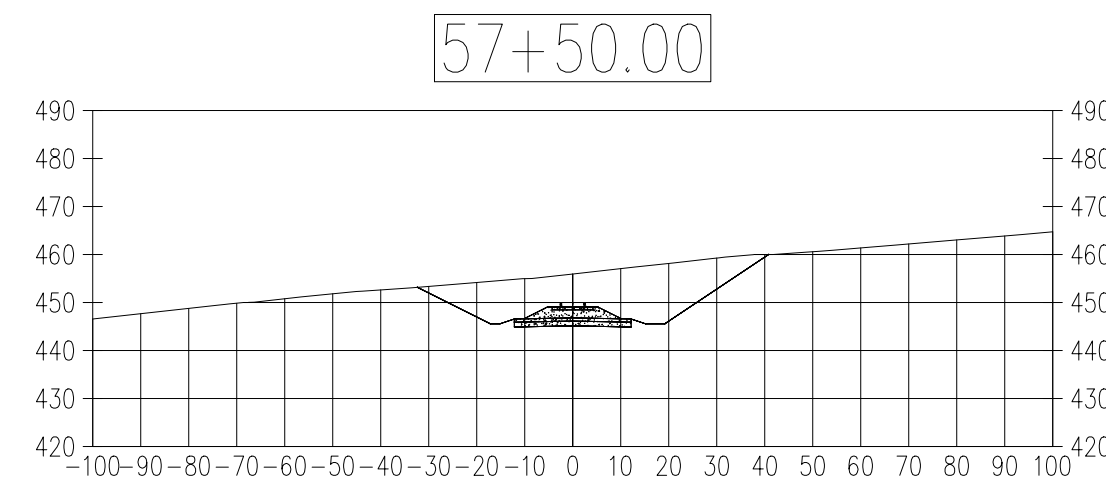
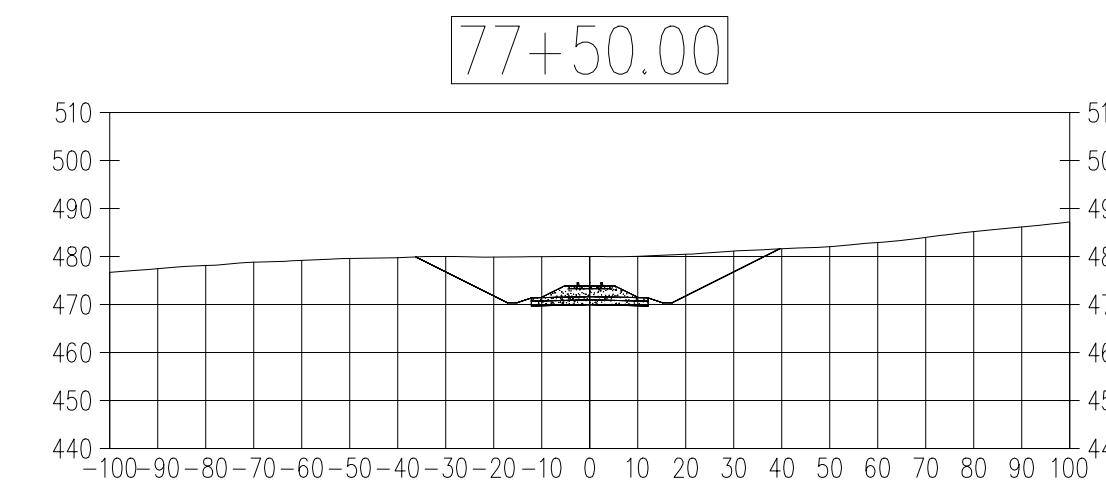
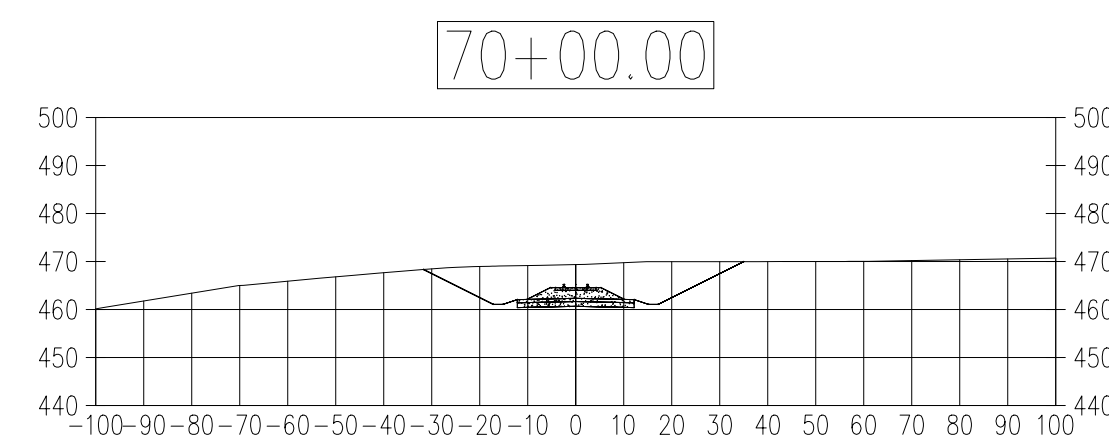
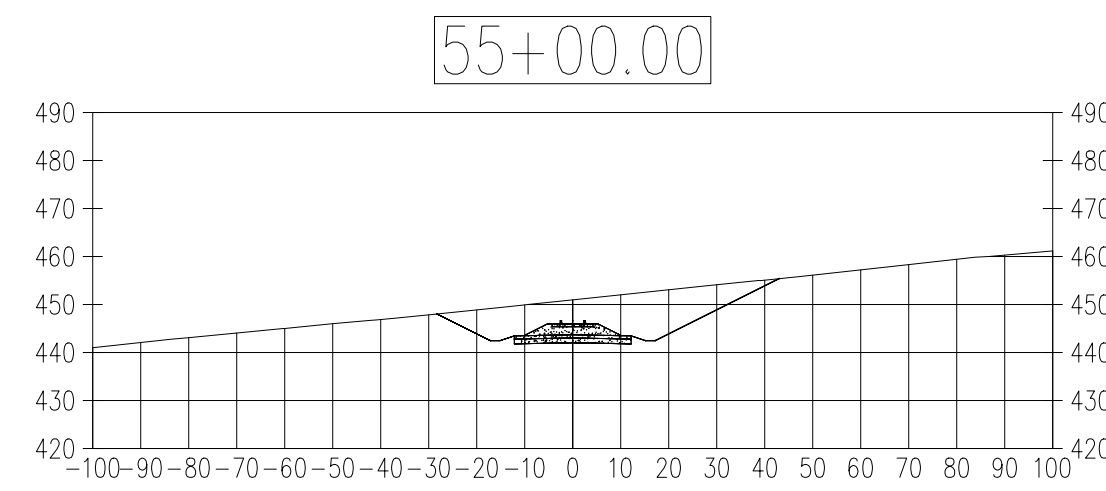
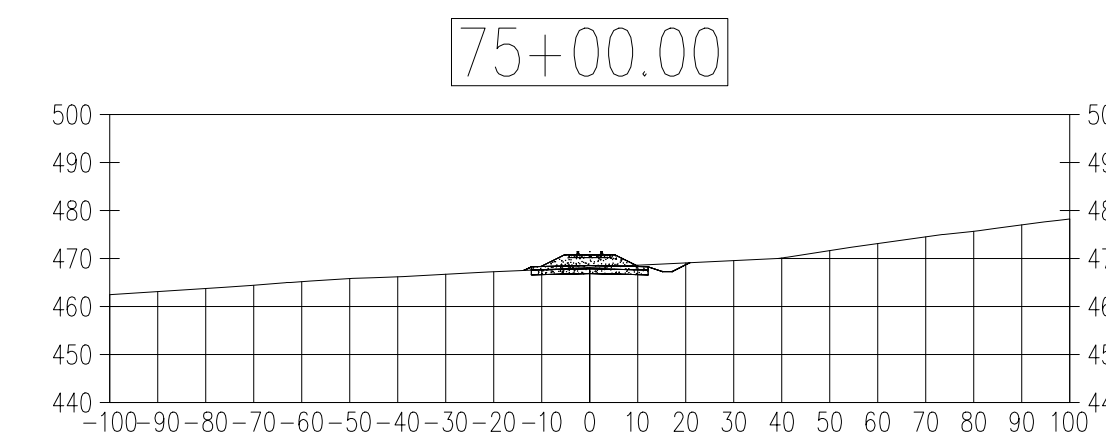
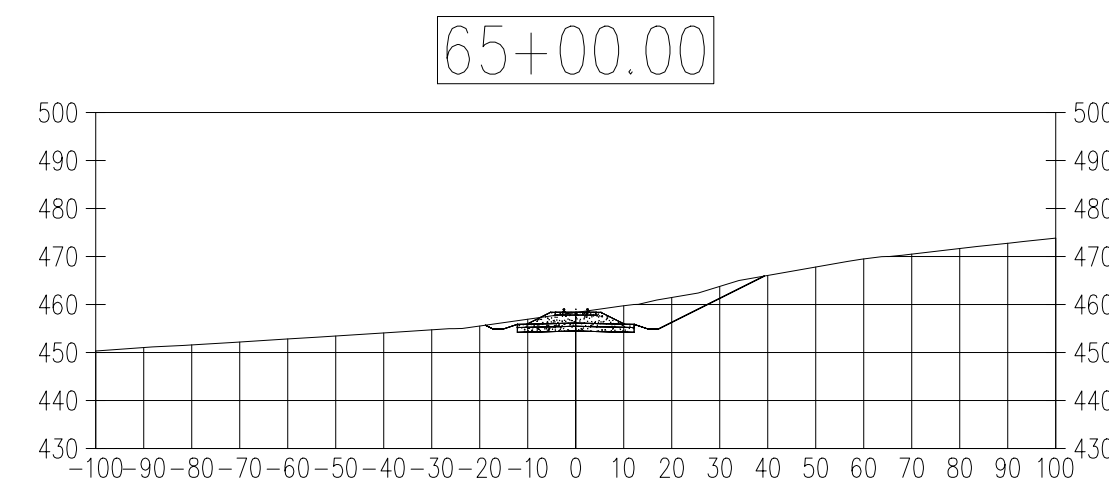
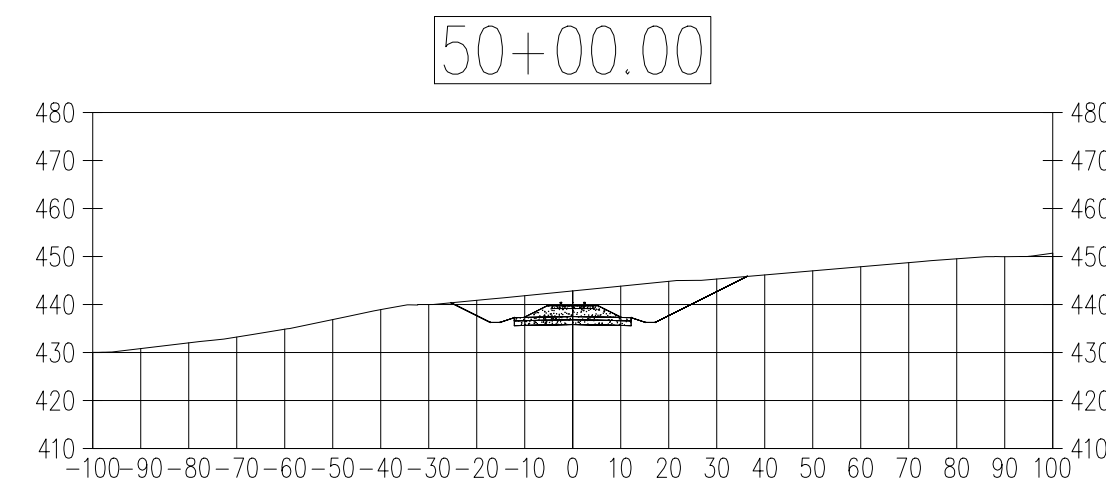

CONCEPTUAL

<b>ONE NORTH MILLINOCKET, MAINE</b>			
MILLINOCKET MILL SITE - RAIL DEVELOPMENT PROPOSED LOOP TRACK SECTIONS			
<b>TEC ASSOCIATES</b> <small>40 MECHANIC STREET SOUTH PORTLAND, MAINE 04106</small>		<small>CONSULTING ENGINEERS</small>	
<b>SCALE</b> 1" = 100'		<b>DATE</b> 24 AUGUST 2022	
<small>JOB NUMBER</small> 22314-1	<small>DRAWN BY</small> B.E.A.	<small>DESIGNED BY</small> B.E.A.	<small>DRAWING NO.</small> --

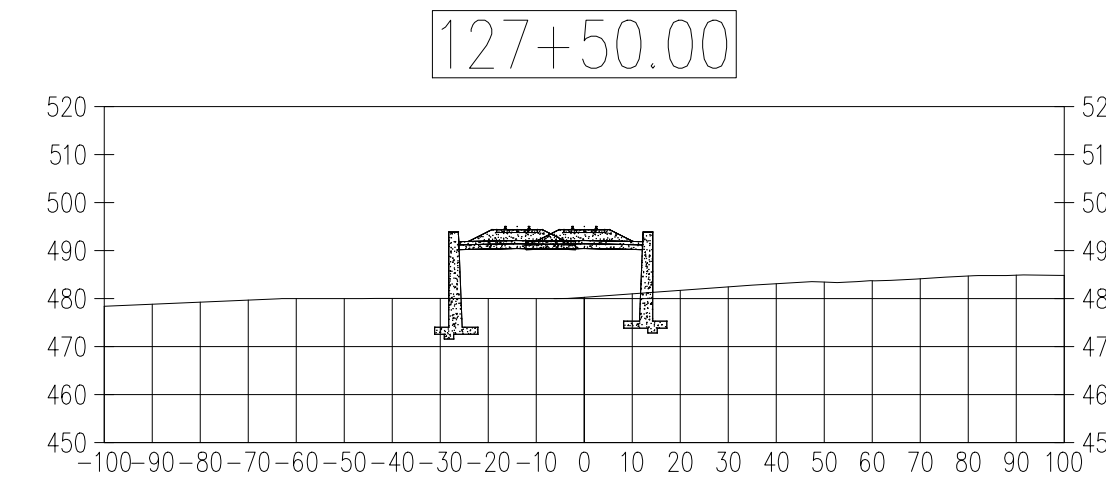
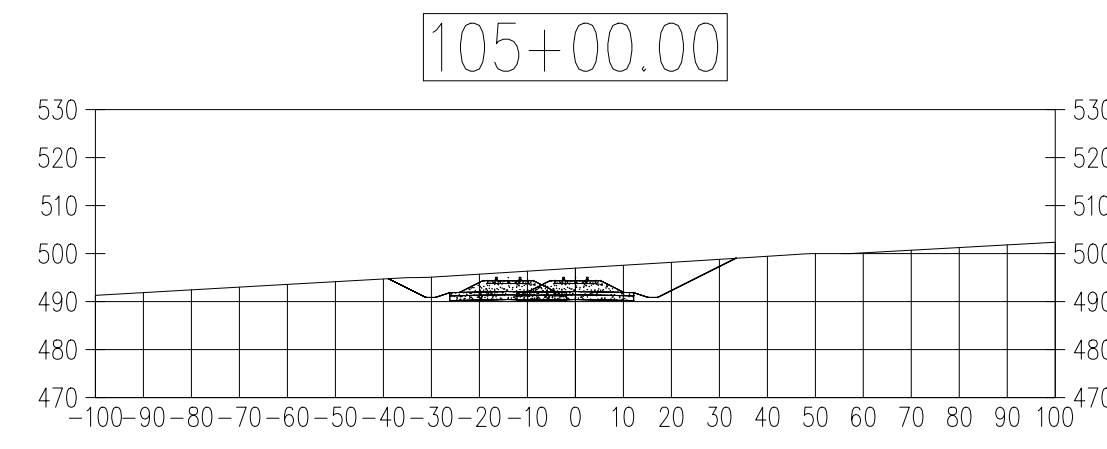
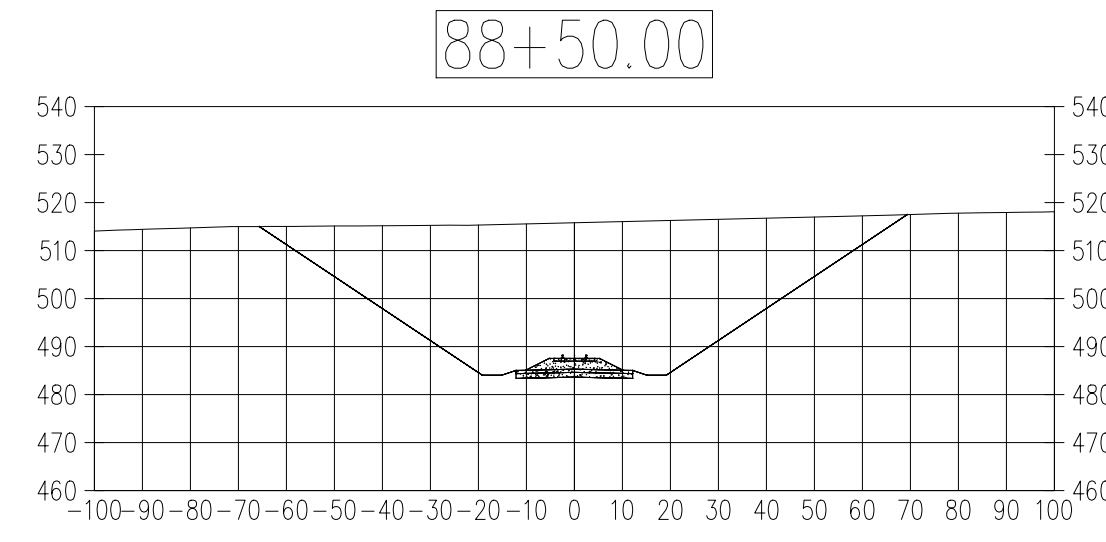
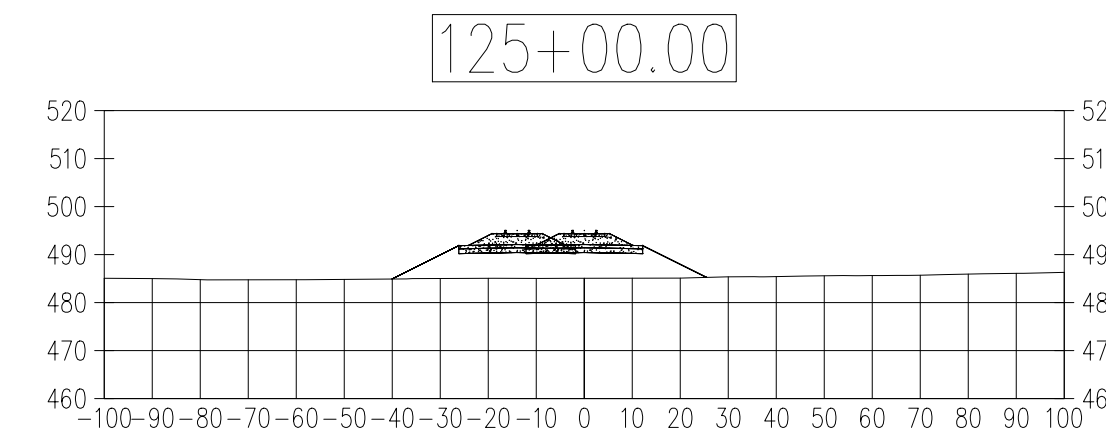
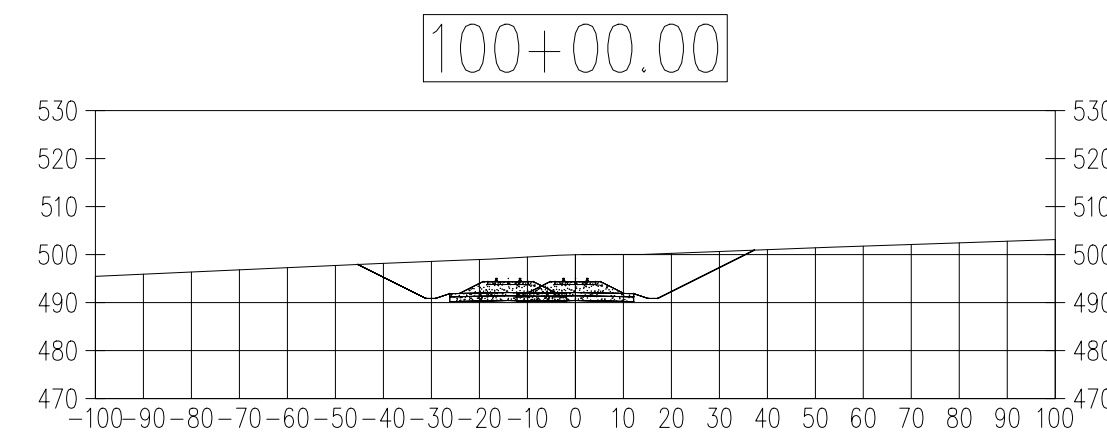
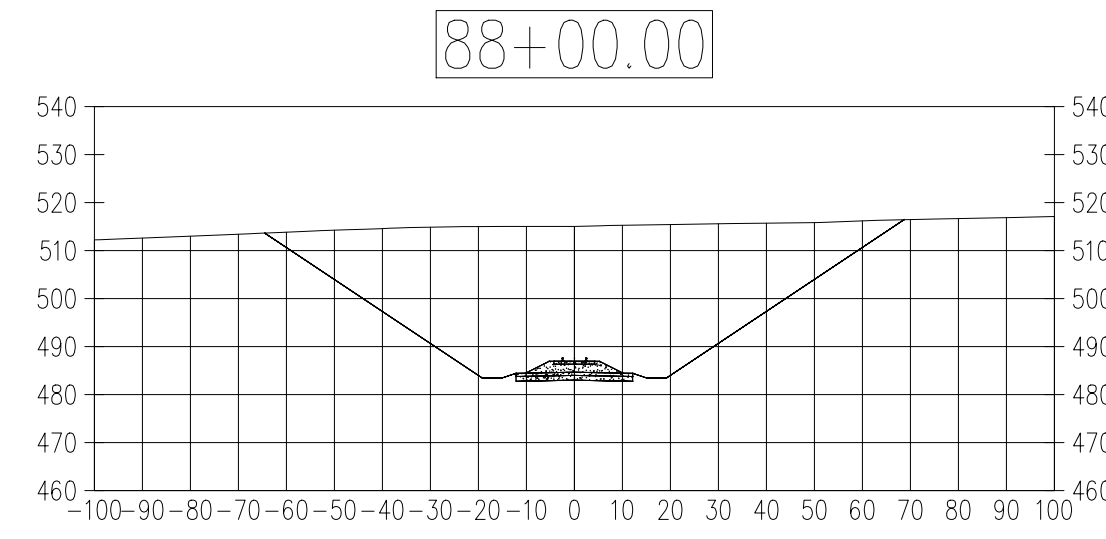
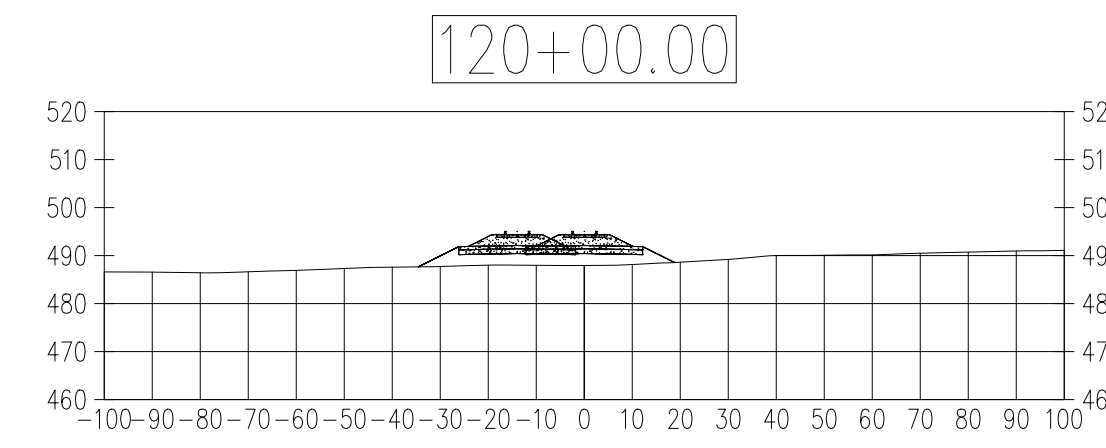
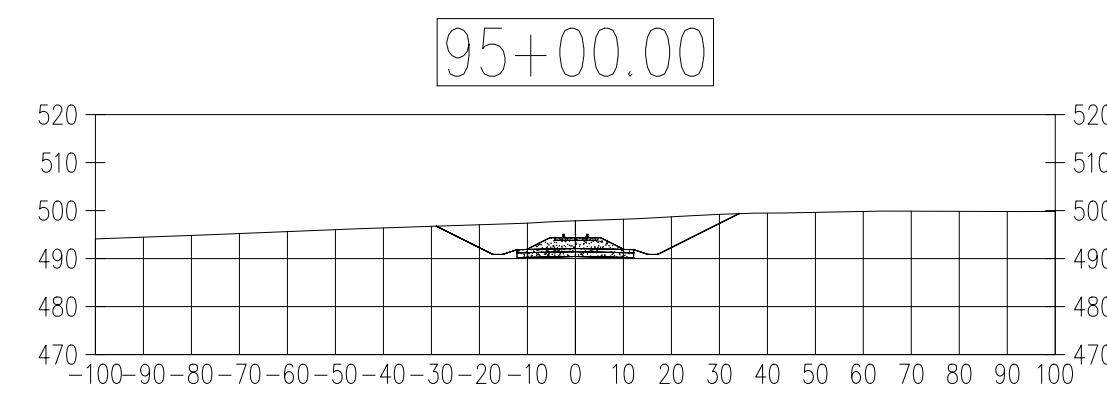
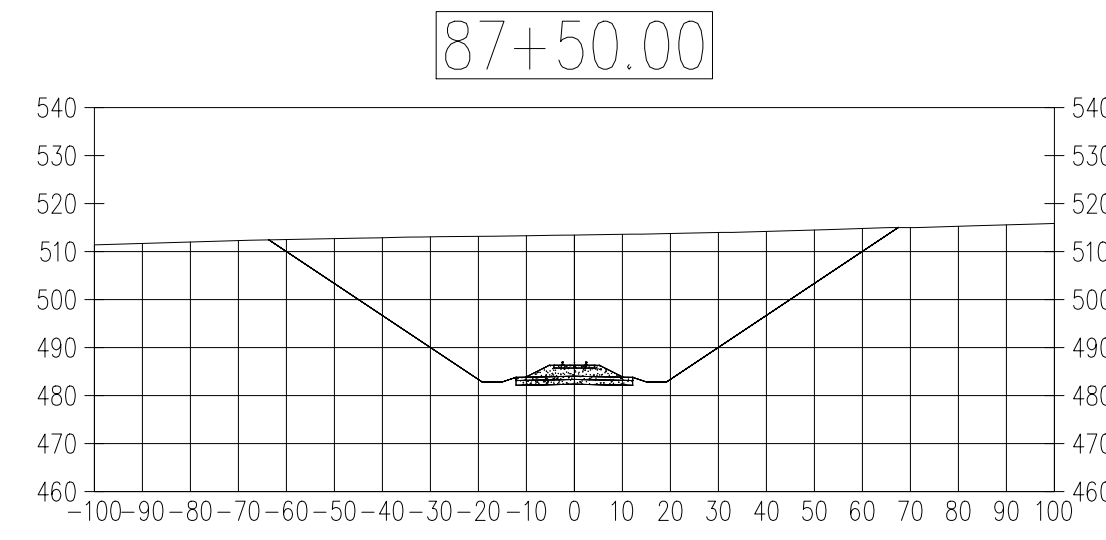
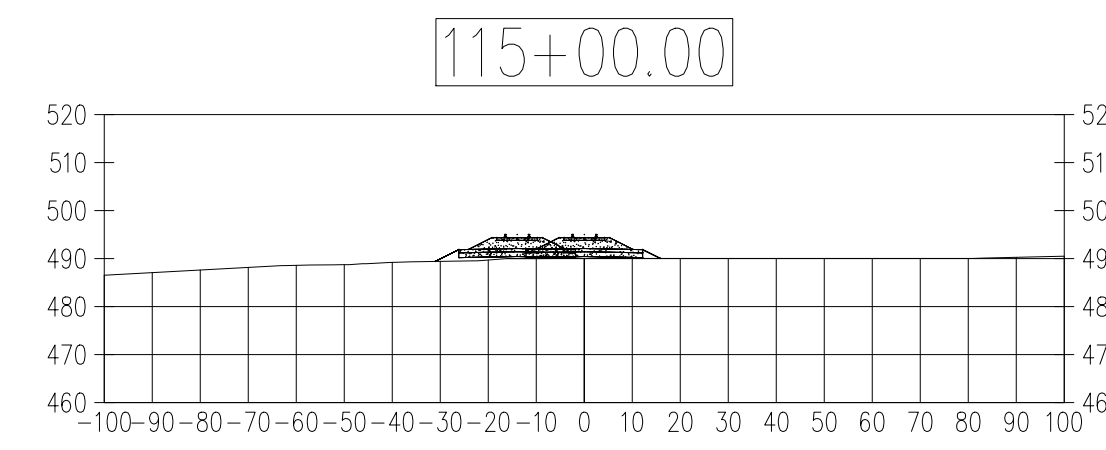
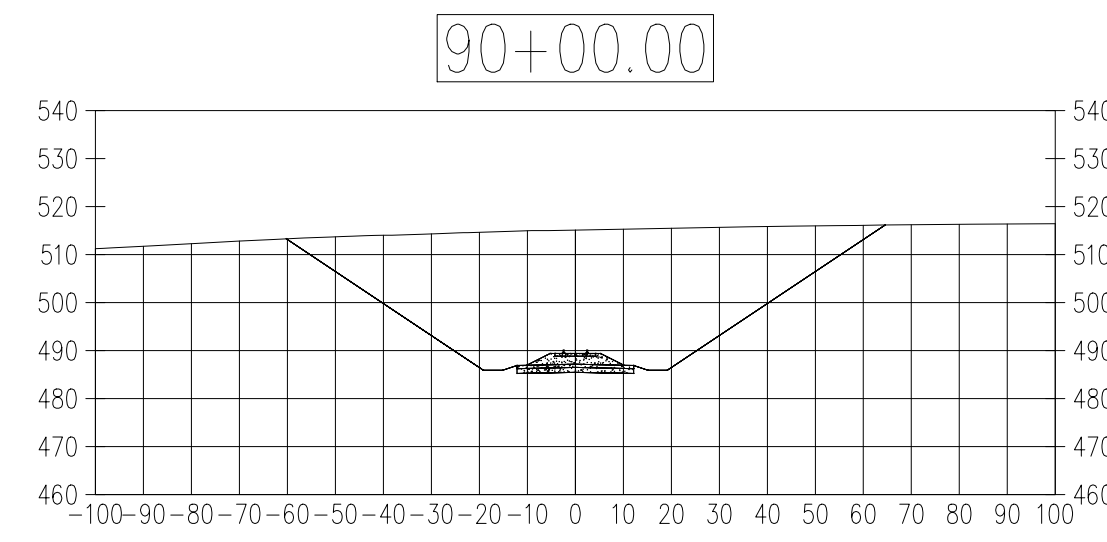
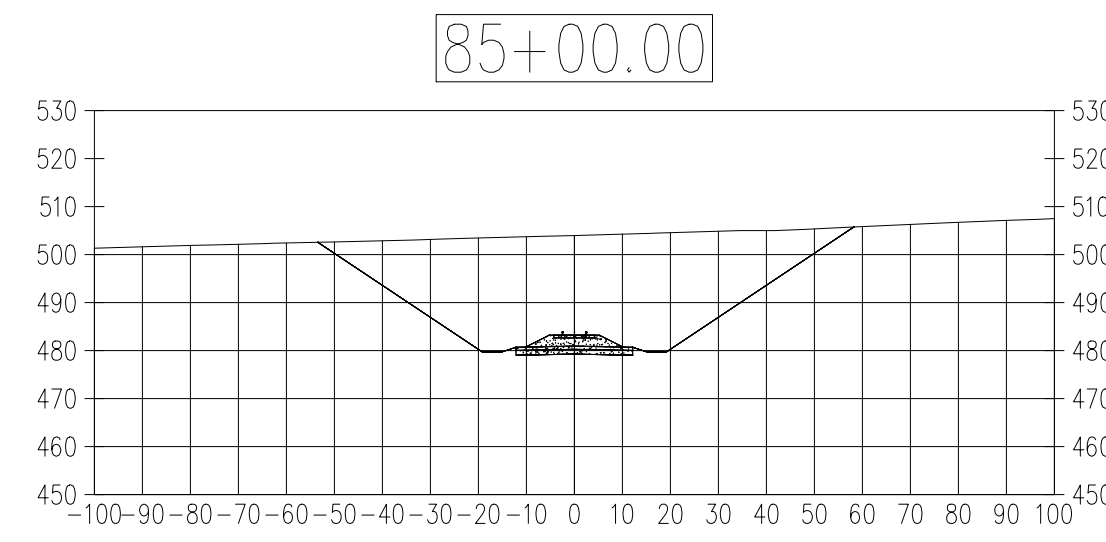
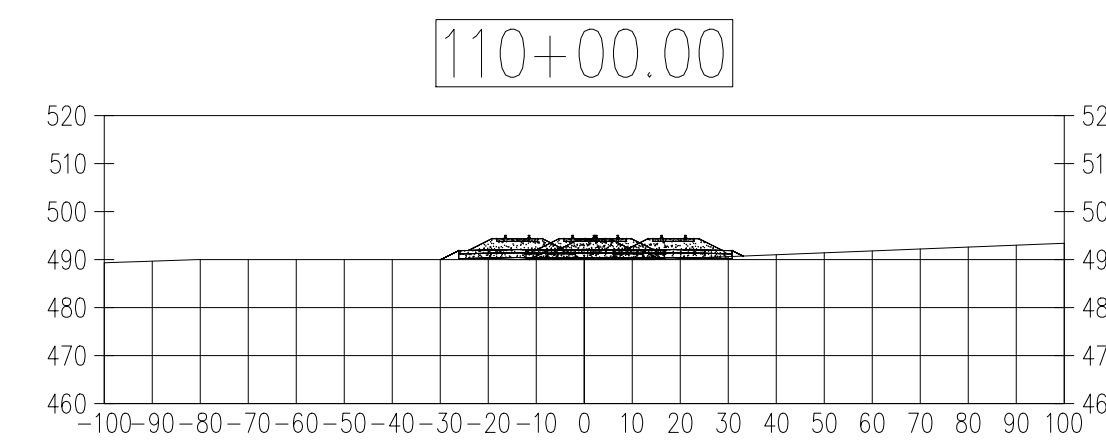
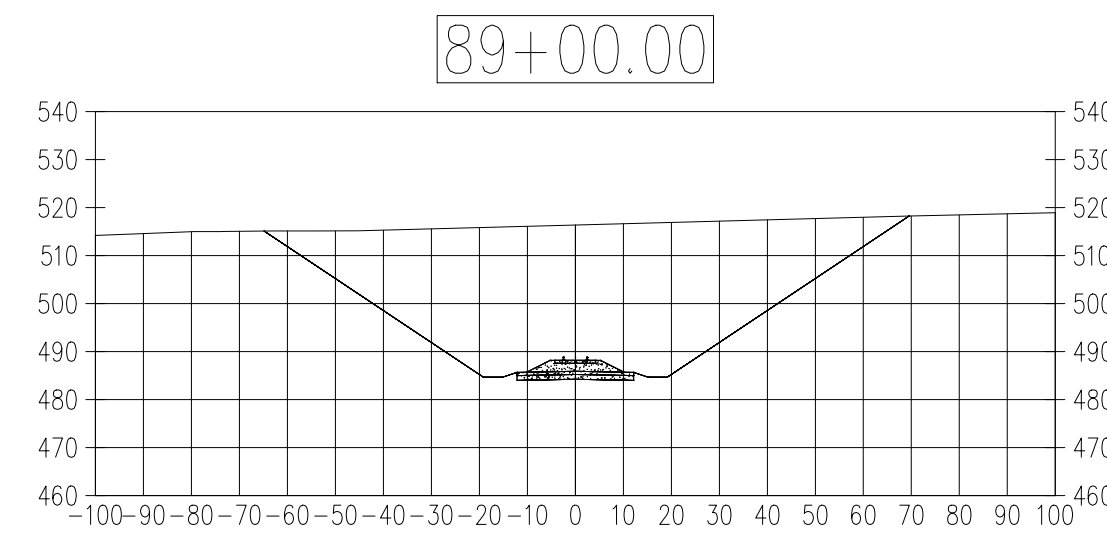
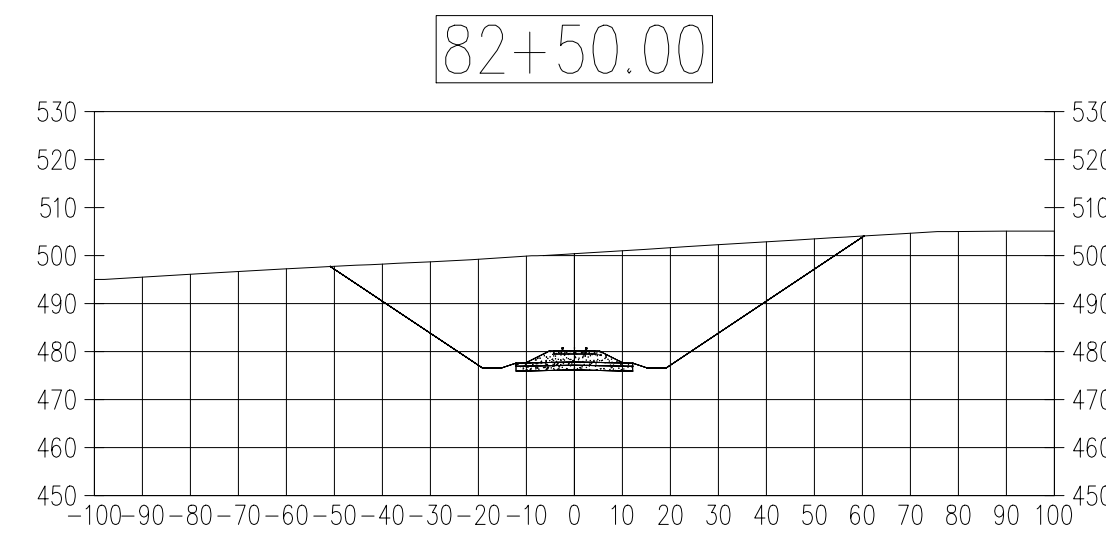

CONCEPTUAL

<b>ONE NORTH MILLINOCKET, MAINE</b>			
MILLINOCKET MILL SITE - RAIL DEVELOPMENT PROPOSED LOOP TRACK SECTIONS			
 <b>TEC ASSOCIATES</b>		<small>CONSULTING ENGINEERS</small>	
<small>40 MECHANIC STREET SOUTH PORTLAND, MAINE 04106</small>		<small>DATE 24 AUGUST 2022</small>	
<small>SCALE 1" = 100'</small>	<small>DRAWN BY B.E.A.</small>	<small>DESIGNED BY B.E.A.</small>	<small>DRAWING NO. --</small>
<small>JOB NUMBER 22314-1</small>	<small>DATE 24 AUGUST 2022</small>	<small>DESIGNED BY B.E.A.</small>	<small>DRAWING NO. --</small>

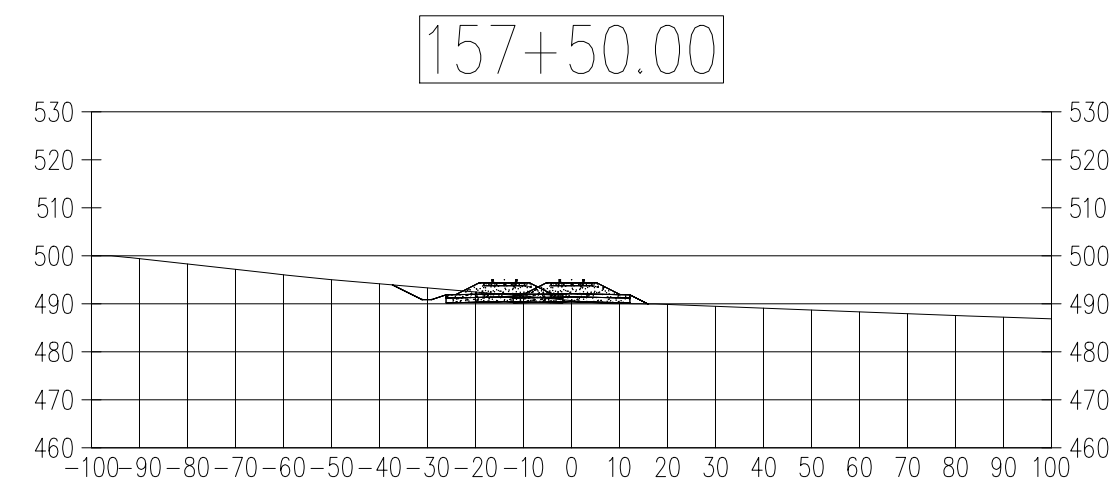
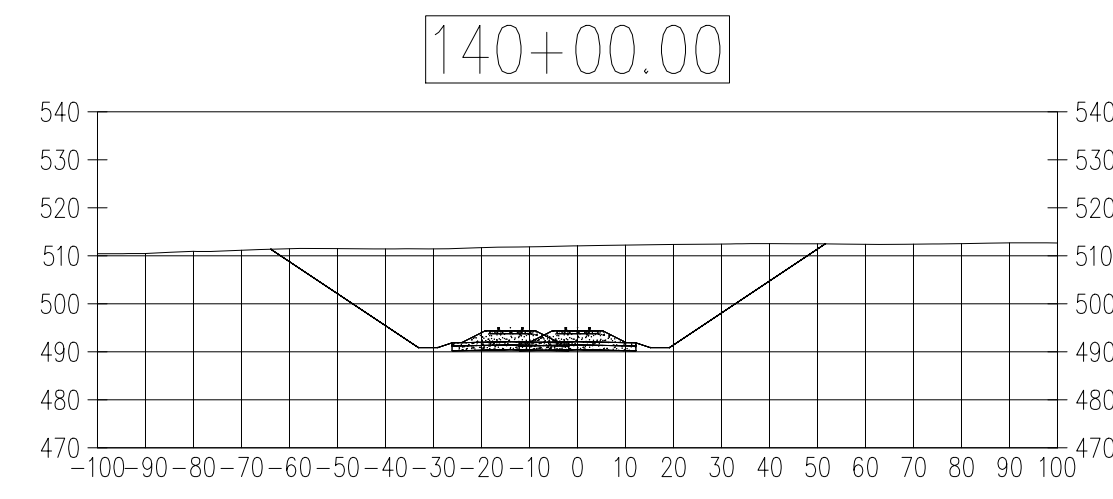
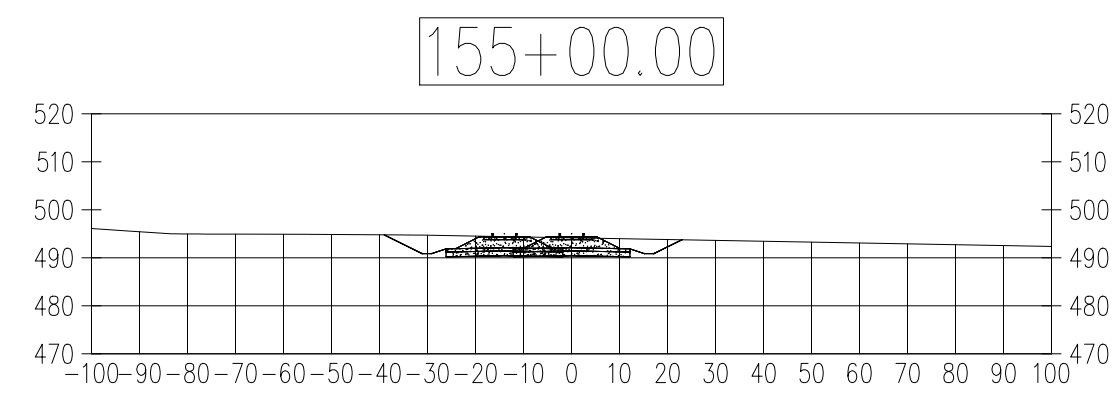
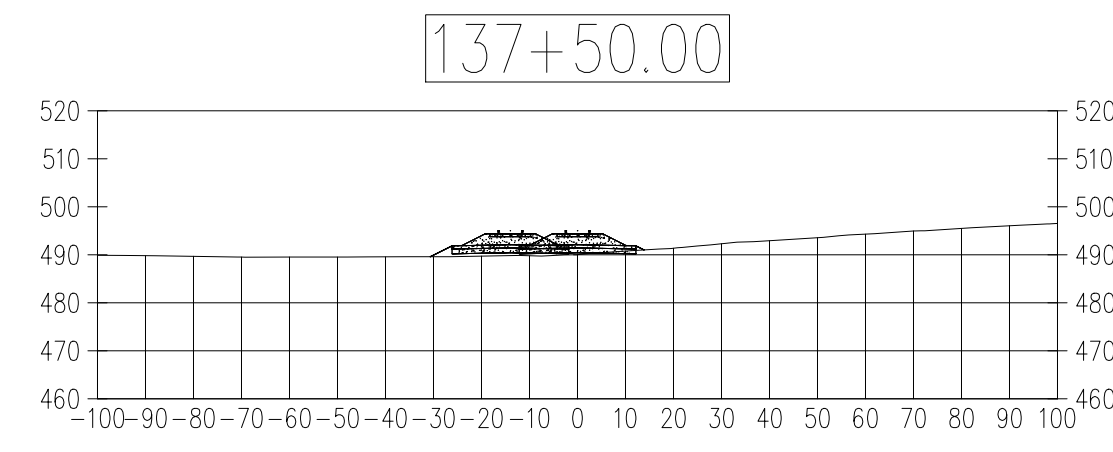
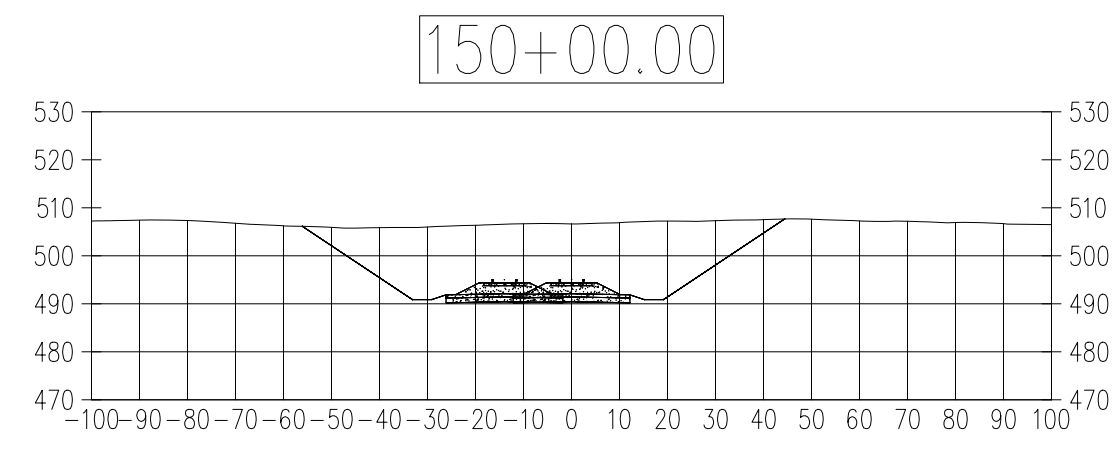
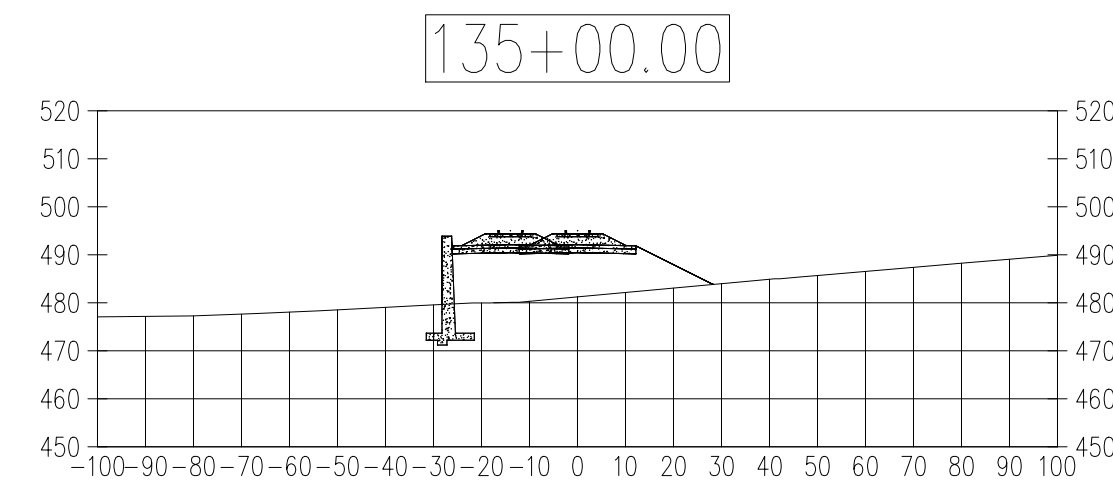
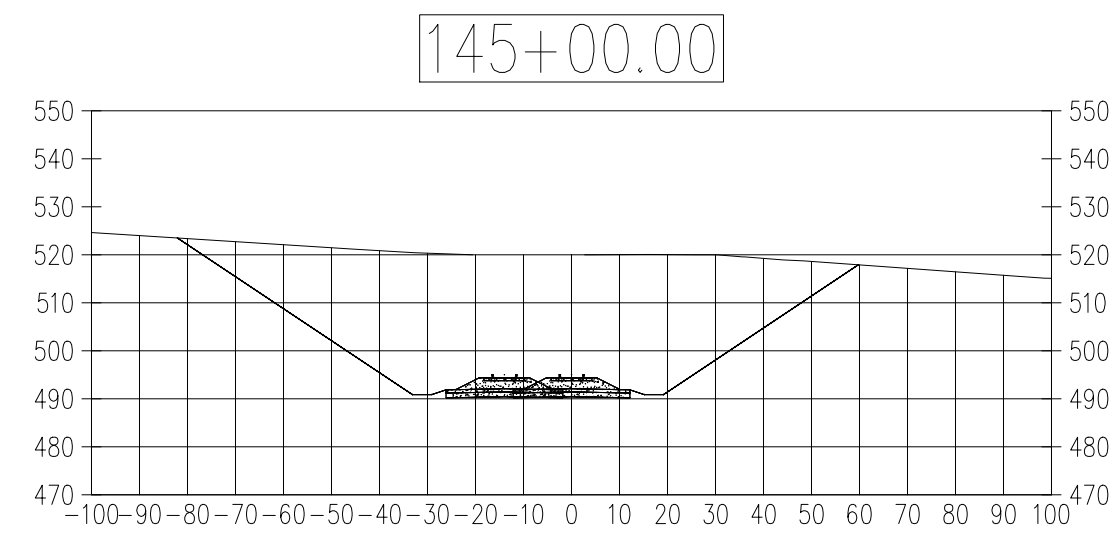
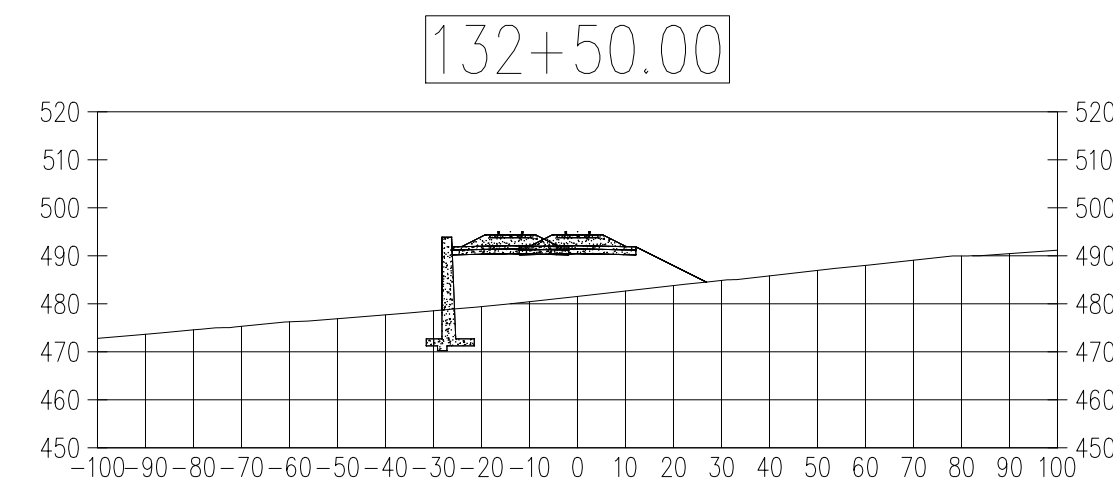
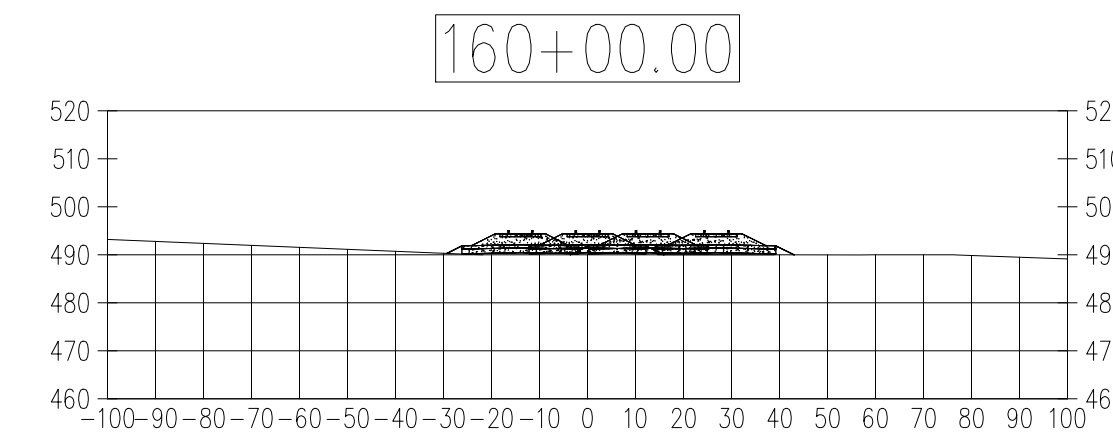
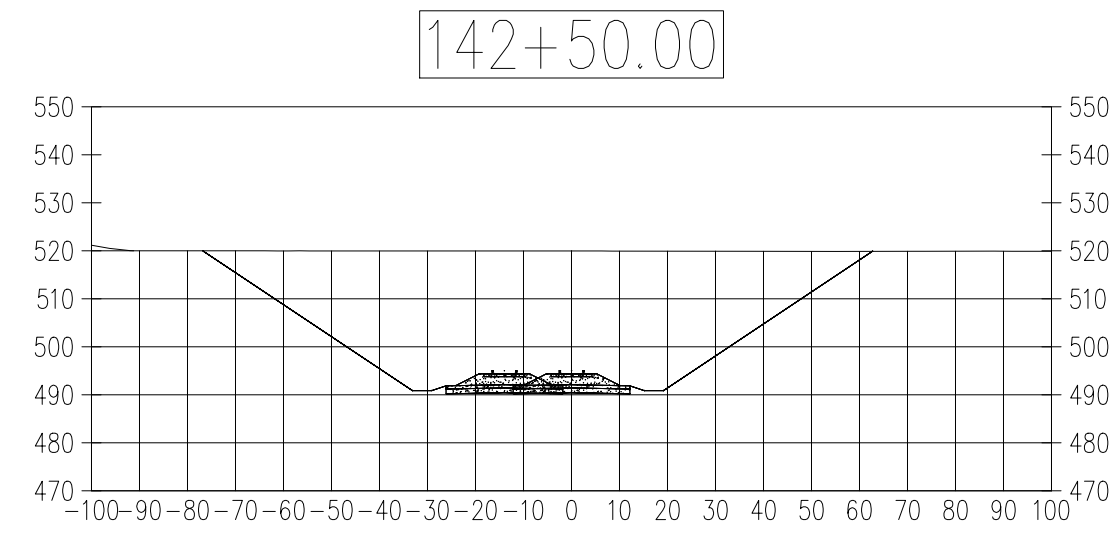
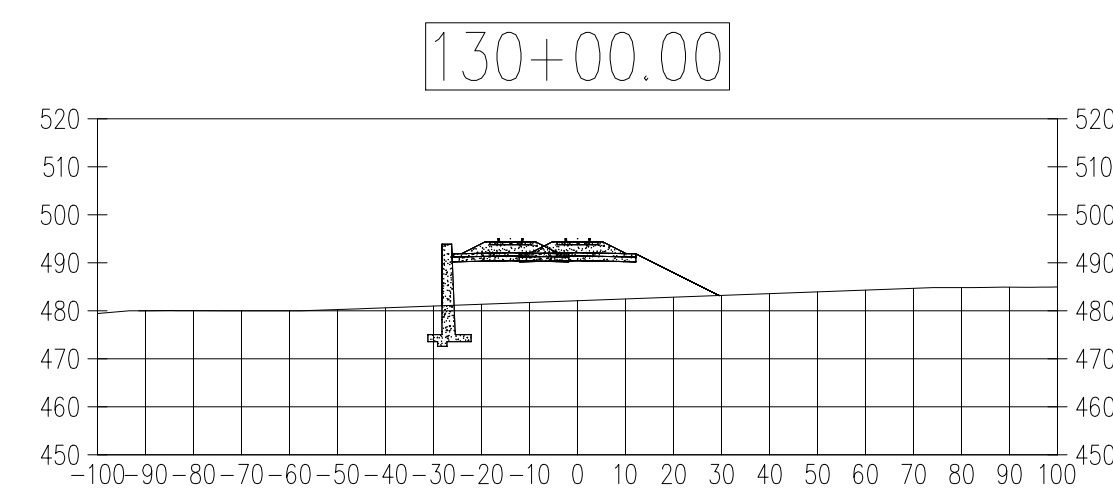

CONCEPTUAL

<b>ONE NORTH MILLINOCKET, MAINE</b>			
MILLINOCKET MILL SITE - RAIL DEVELOPMENT PROPOSED LOOP TRACK SECTIONS			
		CONSULTING ENGINEERS	
<b>SCALE</b> 1" = 100'		<b>DATE</b> 24 AUGUST 2022	
<small>JOB NUMBER</small> 22314-1	<small>DRAWN BY</small> B.E.A.	<small>DESIGNED BY</small> B.E.A.	<small>DRAWING NO.</small> --

# Sketch – Sprague Terminal at Searsport

## Scope

- Reinstall connection to South tracks
- Reinstall connection to storage tracks
- Upgrade Track 5 rail
- Refurbish all other tracks
- Construct Tracks A & B

